

T. 6 S. R. 7 W. W.M.

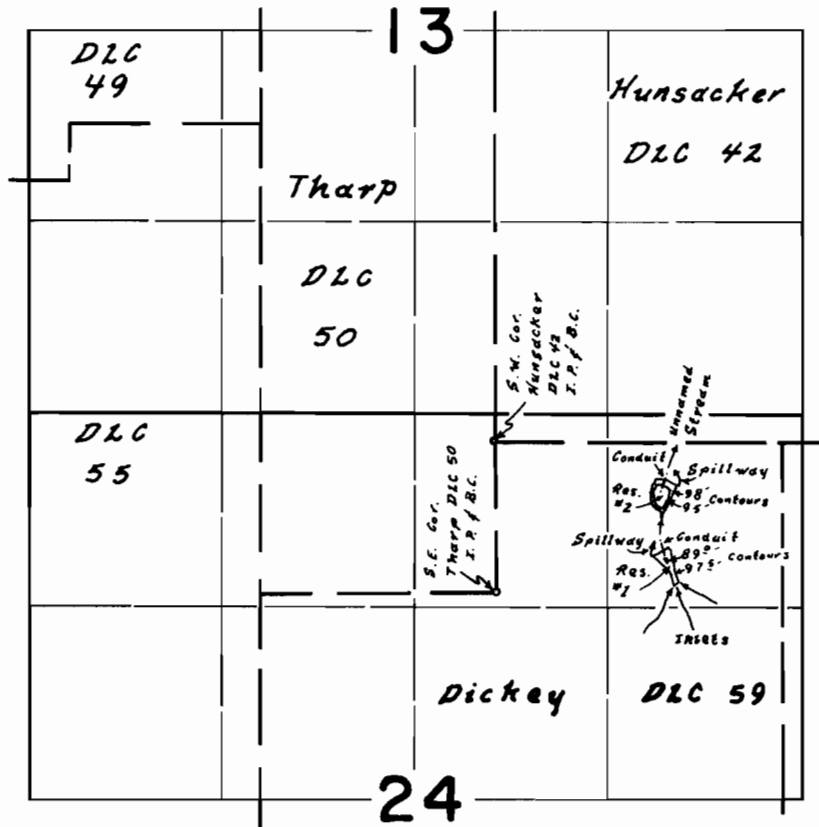

Res. #1 740'S. & 1140'E. }
 Res. #2 250'S. & 1160'E. } All loc. from S.W. Cor. Hunsacker DLC 42

FINAL PROOF SURVEY
 UNDER

R-46407

R-5457

Application No. R-47435 Permit No. R-5716

IN NAME OF

Earl Cook

Surveyed 27 Sept. 1972, by L.E. Gould