

T. 6 S., R. 5 W., W.M.

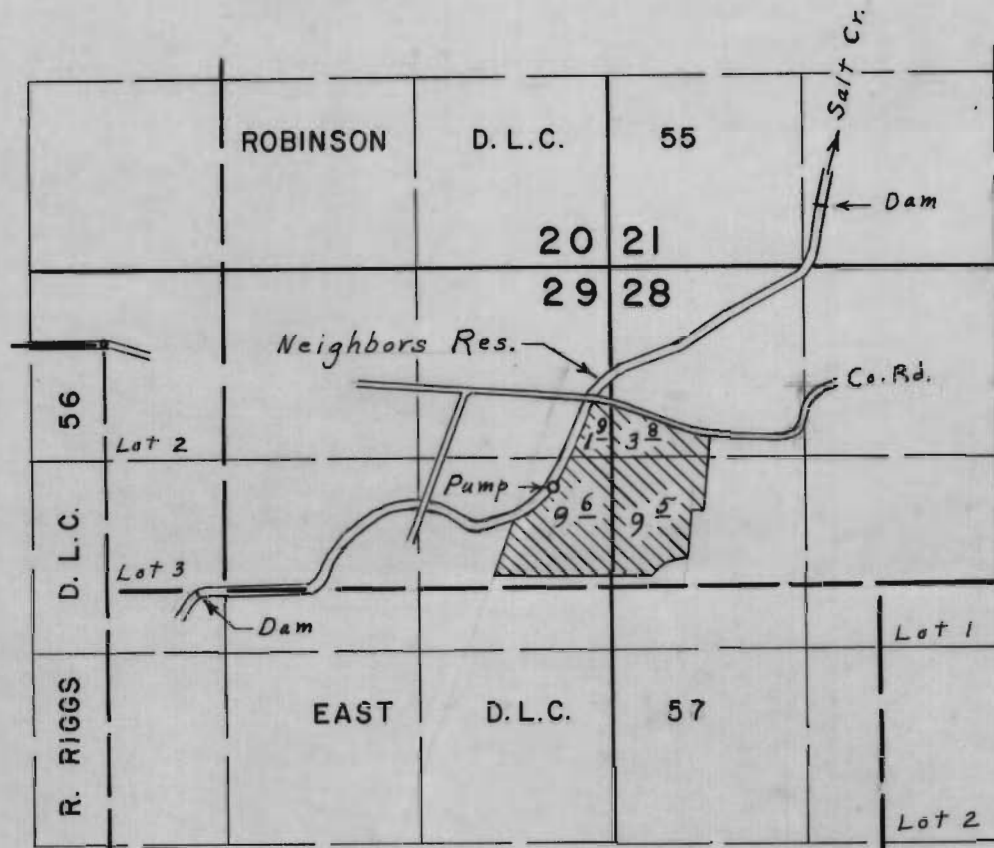

Div. Pts. located: Dam; 920' N. & 4900' E.; Pump, 1000' S. & 3060' E., both from N.E. Cor. R. Riggs D.L.C. 56

FINAL PROOF SURVEY UNDER

Application No. 47621 Permit No. 34969
IN NAME OF

ALPHA L. DAVISON

Surveyed May 25, 1972, by L. E. Gould