

T.1S.R.32 E.W.M.

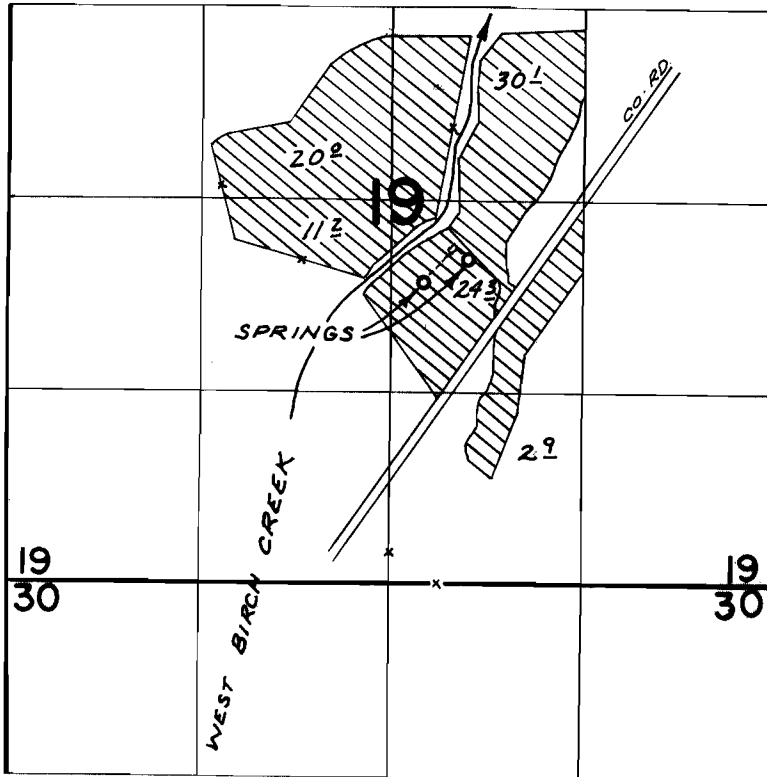

SPRINGS LOC: 2070'N. & 220'E.; 2220'N. & 530'E., BOTH FROM S $\frac{1}{4}$ COR. SEC. 19

FINAL PROOF SURVEY UNDER

Application No. 37796 Permit No. 28354
IN NAME OF

ARNOLD C. HOEFT

Surveyed JUNE 22 1971, by G. BACA
AUG. 20, 1964 J.C. GARDNER

R.G.M.
1971-B & 1964-N