

T.78&8S. R.46E. WM.

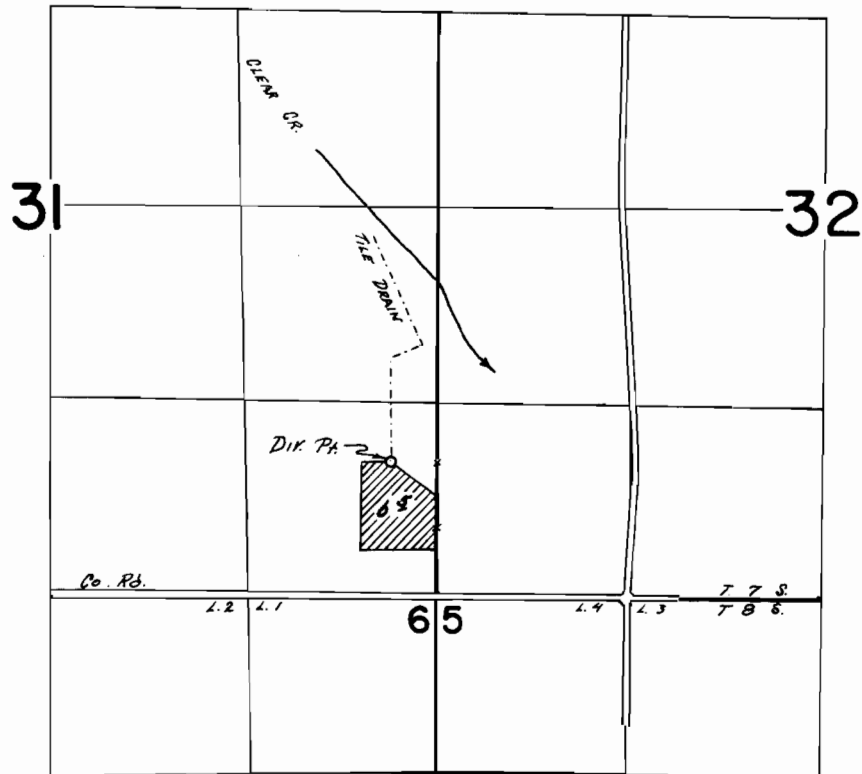

Div. Pt. Loc. 930' N + 310' W From SE Cor Sec 31

FINAL PROOF SURVEY
UNDER

Application No. G-3245 Permit No. G-3047
IN NAME OF

RICHARD S. TOWELL

Surveyed July 18 1970, by D. P. BUEHL
June 22 72 R. B. MUCKEN