

T. 6 S. R. 7 W. W.M.

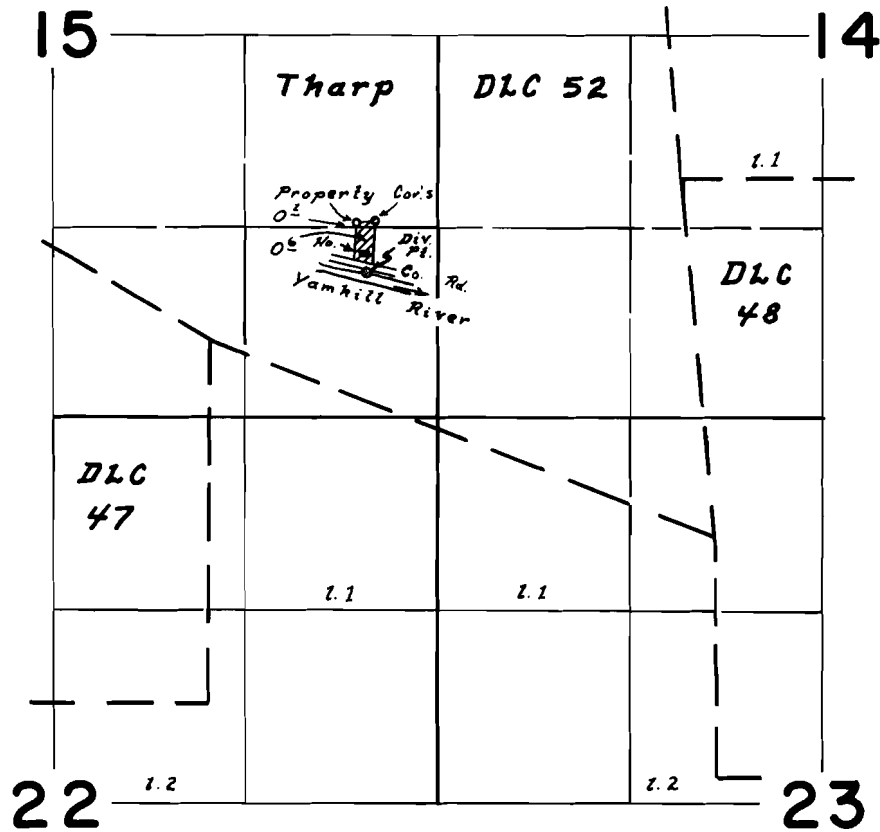

Div. Pt. Loc. 1000' N. & 490' W. from S.E. Cor. Sec. 15

FINAL PROOF SURVEY
UNDER

Application No. 45922 Permit No. 34309
IN NAME OF
Thomas E. Manis

Surveyed 13 June 1972, by *L. E. Gould*