

T. 7 S. R. 5 W. W. M.

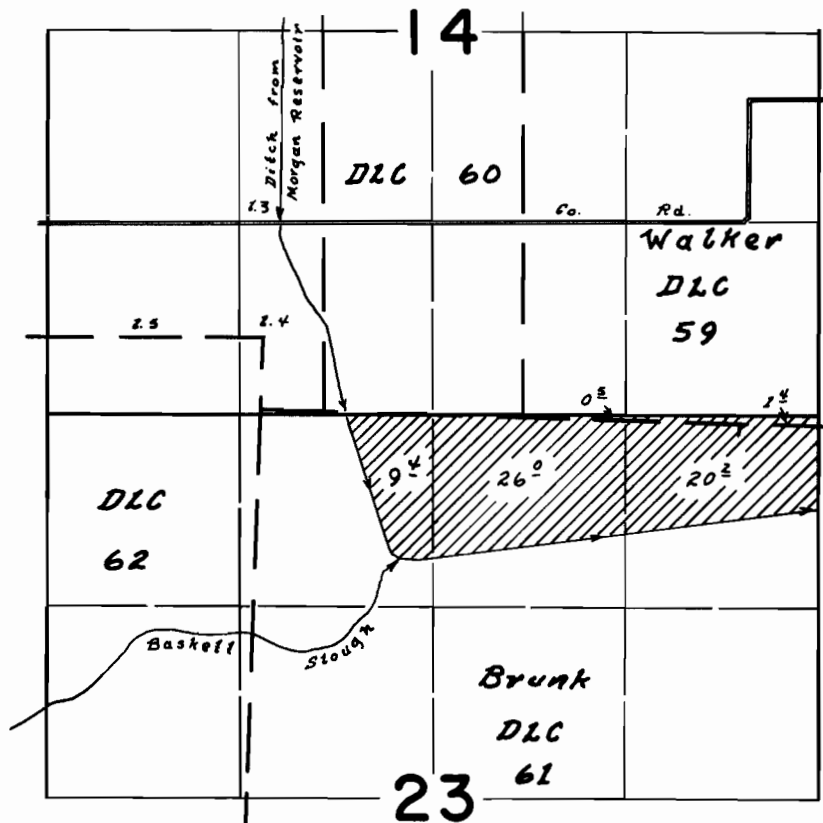

Div. Pl. at Morgan Reservoir loc. 880'S. of 1690'W. from N.W. Cor. Smith DLC 44

FINAL PROOF SURVEY
UNDER

Application No. 47021 Permit No. 35176
IN NAME OF
United States of America
Department of the Interior, Fish & Wildlife Service

Surveyed 17 Aug. 1972, by L.E. Gould