

T. 6 S. R. 7 W. W.M.

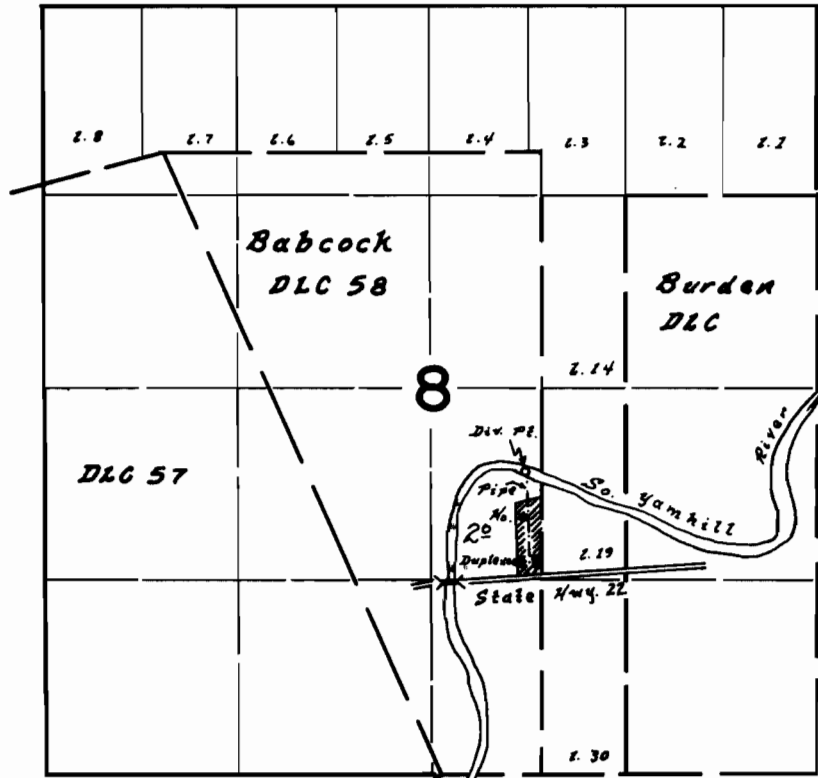

Div. Pt. Loc. 2080' N. & 110' W. from S.E. Cor. Babcock DLC 58

**FINAL PROOF SURVEY**  
UNDER

Application No. 47214 Permit No. 35367  
IN NAME OF

Ernest G. Hollmann

Surveyed 26 Sept. 1972, by A.F. Gould