

T. 38 S. R. 7 & 8 W. W.M.

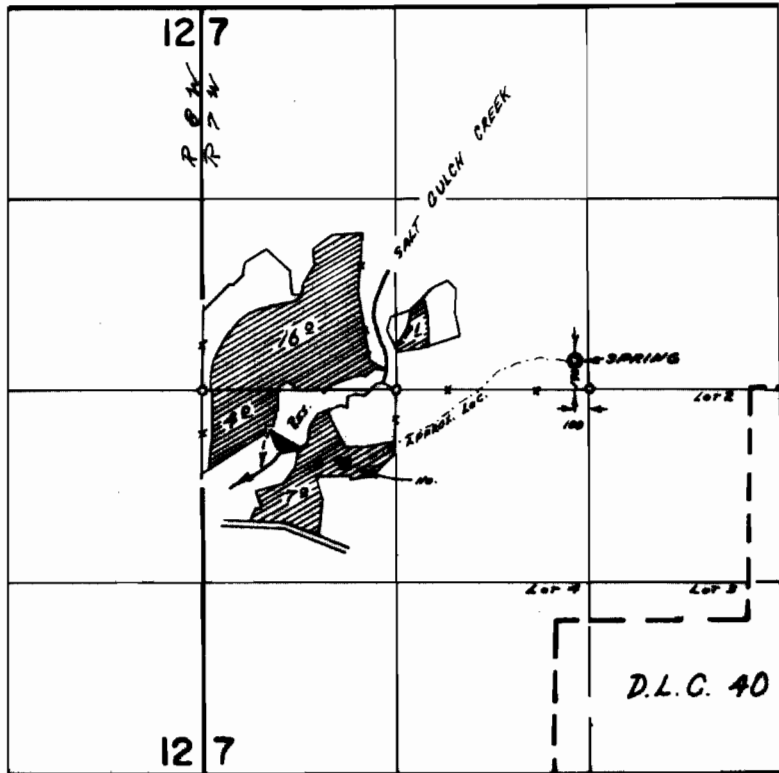

Div. Pt. Loc: 360' S. & 570' E. FROM NW COR. SEC. 7

**FINAL PROOF SURVEY**  
UNDER

R-41470                      R-4608  
 41382                      30623  
 Application No. 25235... Permit No. 33793...  
 IN NAME OF

.....CHARLES S. MOORE.....

Surveyed APR 17 1970, by D. R. BUELL