

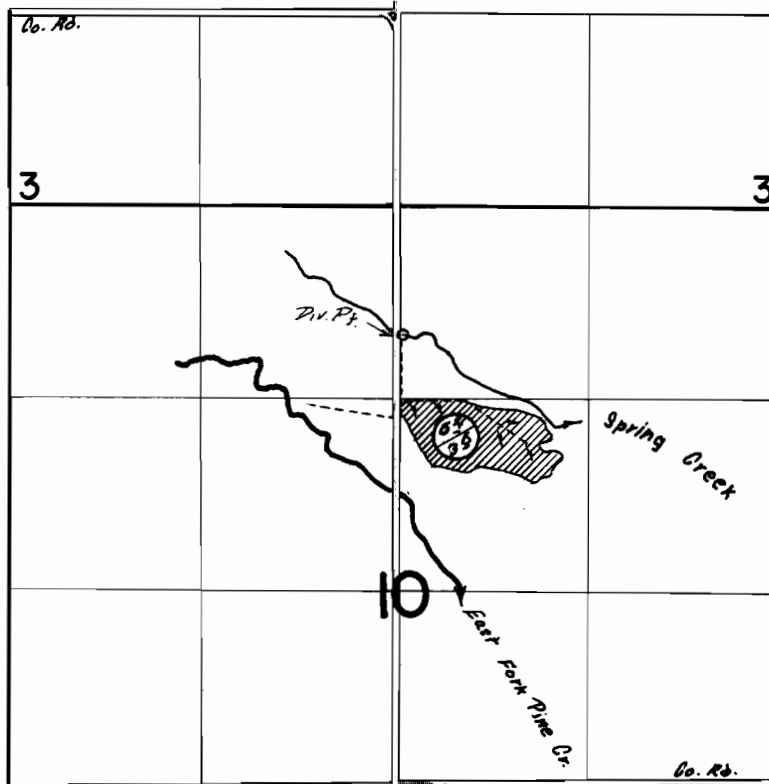

T.8S. R.46E. W.M.



 PRIMARY
 SUPPLEMENTAL
Div. Pt. Loc. 490' N 1 30' E FROM SW COR NW 1/4 NE 1/4 SEC. 10

FINAL PROOF SURVEY
UNDER

Application No. 39692 Permit No. 29578
IN NAME OF

JOHN D. and CAROL A. WEST

Surveyed June 26 1972, by R. G. MURKIN