

T. 7S. R.45E. W.M.

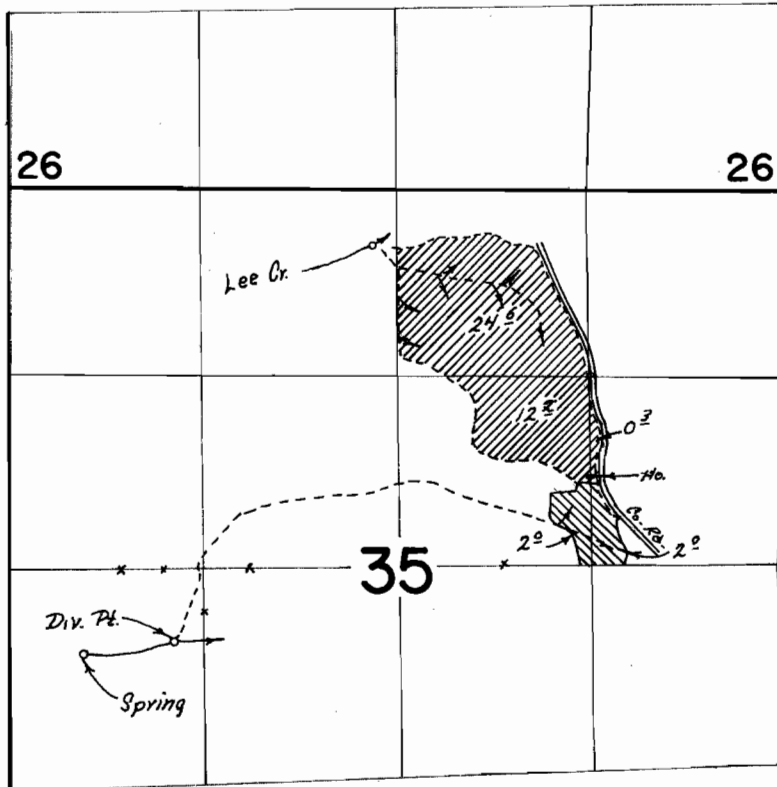

Lee Cr. Div. Pt. Loc. 390' S & 170' W From N 1/4 Cor. Sec. 35  
Div. Pt. Loc. 570' S & 200' W From NE Cor. NW 1/4 SW 1/4 Sec 35

**FINAL PROOF SURVEY**  
UNDER

Application No. 40940 Permit No. 30507  
40934 IN NAME OF



HUGH BRATEN

Surveyed June 22, 1972, by R. B. Mucken