

T.27S., R.12W., W.M.

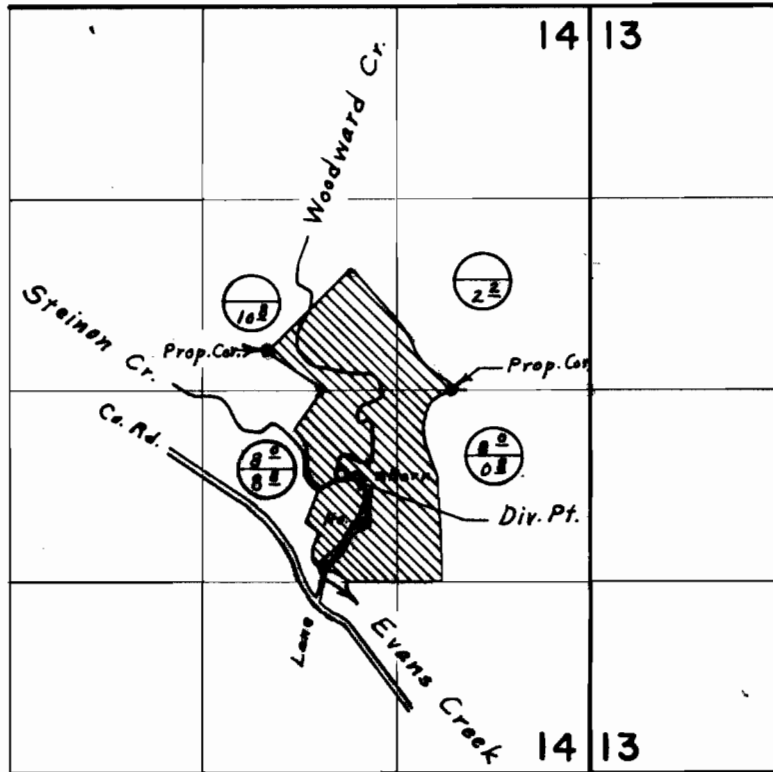

Div. Pt. located 570' S. & 1690' W. From E. 1/4 Cor. Sec. 14

Certificate 9550
Permit 32013



FINAL PROOF SURVEY
UNDER

Application No. 42832. Permit No. 32013.
IN NAME OF

J. C. STEWART

Surveyed July 13, 1972, by L. E. Gould.