

T.29S.R.IIW.W.M.

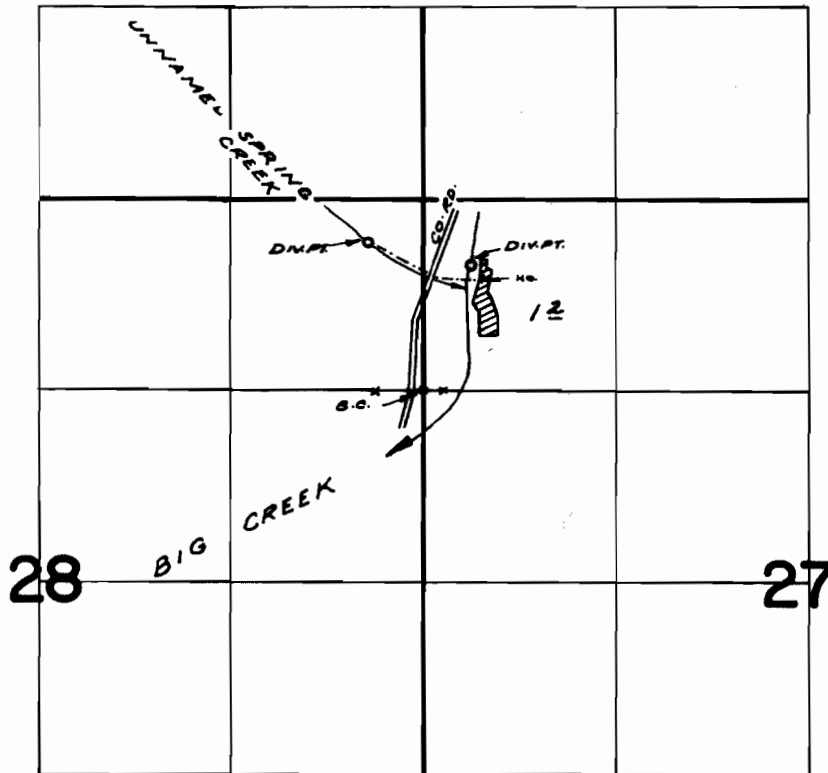

DIV. PTS. LOC: 860' N. & 320' E ; 1020' N. & 380' W, Born FROM S.W. COR. NW $\frac{1}{4}$ NW $\frac{1}{4}$ SEC. 27

FINAL PROOF SURVEY UNDER

Application No. 46098 Permit No. 34442
IN NAME OF

JOHN J. LA SALANDRA

Surveyed JULY 13, 1972, by R. MUCKEN