

T.24S.R.13W.W.M.

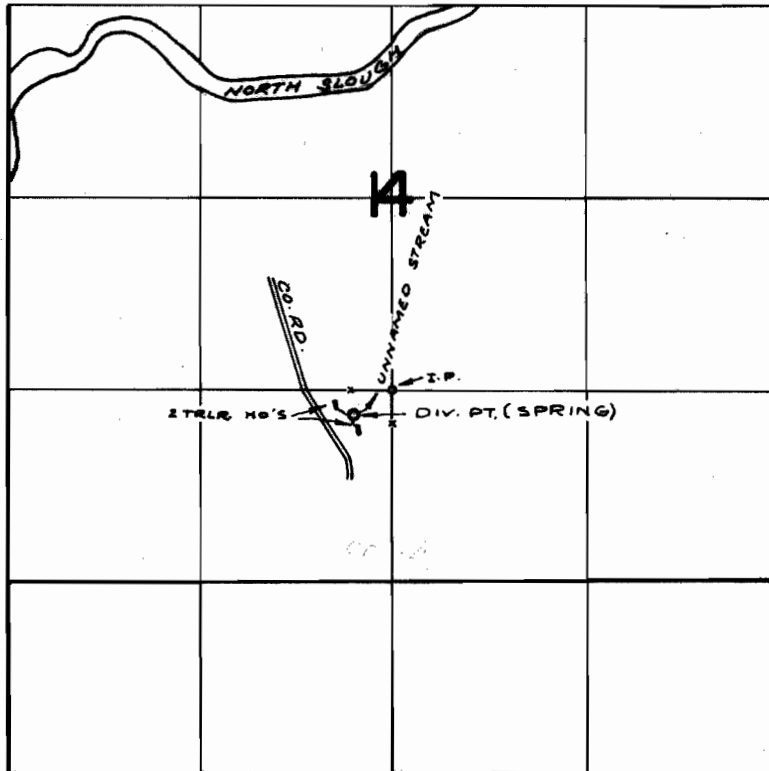

DIV. PT. (SPRING) LOC: 170'S. E 270' W. FROM N.E. COR.
SE 1/4 SW 1/4 SEC. 17

FINAL PROOF SURVEY
UNDER

Application No. 47012 Permit No. 35171
IN NAME OF

PECOS A. & MELBA J. MARTIN

Surveyed AUG. 7, 1972, by R. MURKIN