

T. 36 S. R. 7 W. W. M.

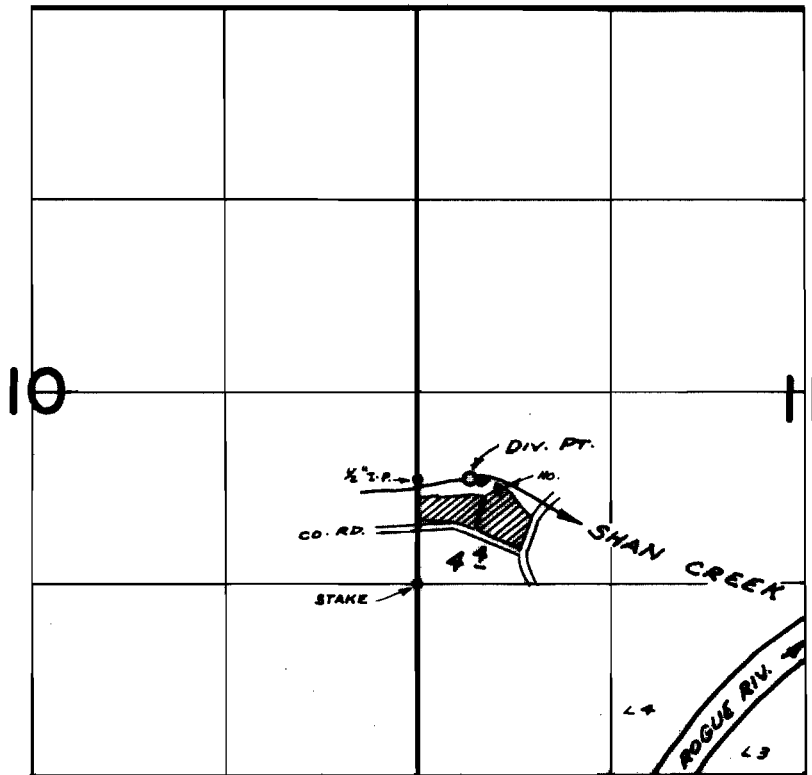

DIV. PT. LOC: 720' N. & 360' E. FROM S.W. COR. NW 1/4 SW 1/4 SEC. 11

FINAL PROOF SURVEY
UNDER

Application No. 41400 Permit No. 30225
IN NAME OF

JACK C. KUCH

Surveyed APR. 19, 1972, by R. MUCKEN