

T.5S., R.4W., W.M.

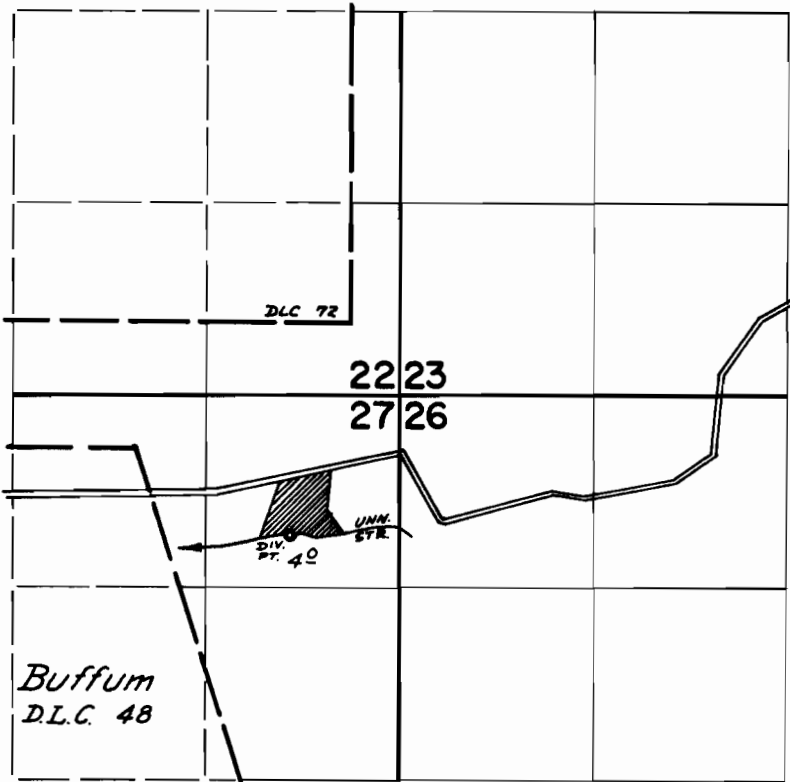

DIV. PT. LOCATED: 500' S & 1050' E FROM NE COR BUFFUM DLC 48.

**FINAL PROOF SURVEY**  
UNDER

Application No. 46138 Permit No. 34470  
IN NAME OF

FRED W. HANSEN

Surveyed May 18 1972, by D. Norby