

T. 28 S. R. 12 W. W. M.

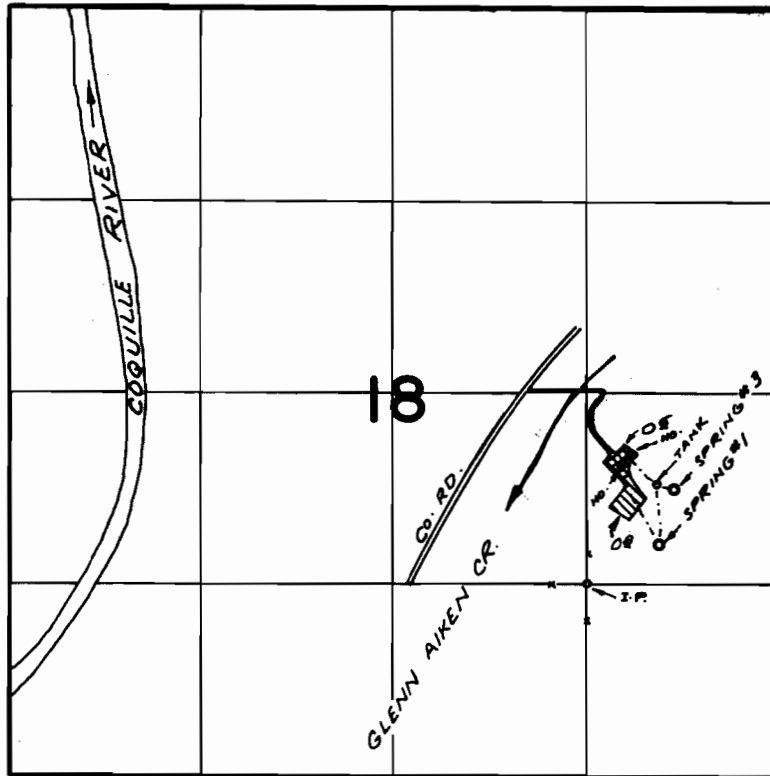

▨ → IRR. SPRING #1 ▨ → IRR. SPRING #3
SPRINGS LOC: #1 - 280' N & 500' E ; #3 - 660' N & 600' E,
BOTH FROM SW. COR. SEC. NE 1/4 SEC. 18

FINAL PROOF SURVEY
UNDER

Application No. 42418 Permit No. 31740
IN NAME OF

NINA E. FISHER & THE ESTATE OF
ROBERT W. FISHER

Surveyed JULY 18 1972, by R. MUCKEN