

T.28S.,R.11W.,W.M.

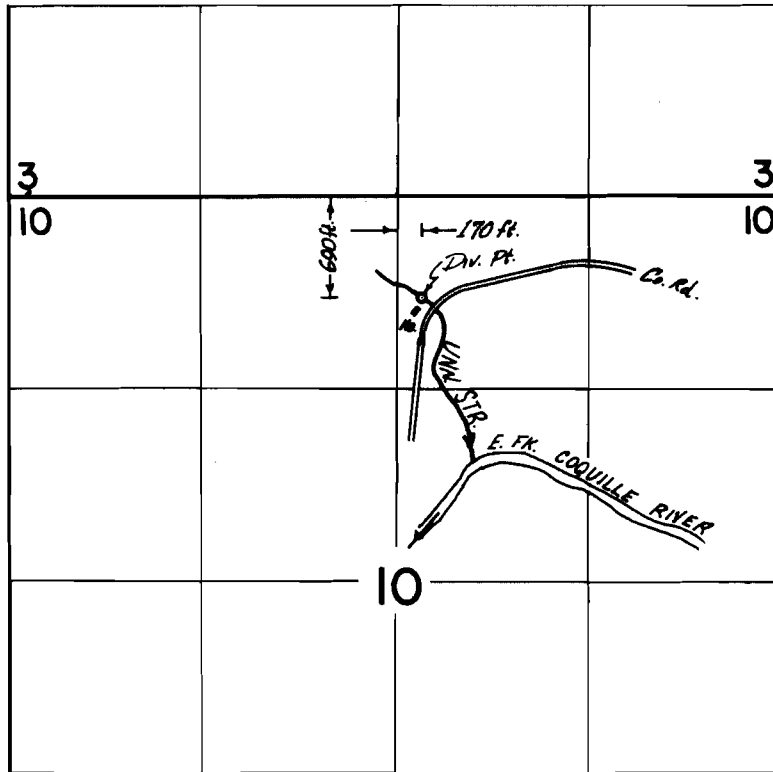

**FINAL PROOF SURVEY**  
UNDER

Application No. 46190 Permit No. 34516  
IN NAME OF

MYRON B. ANDERSON

Surveyed 15 JULY 1972, by L.E. GOULD

RECEIVED  
JUN 22 1969  
STATE ENGINEER  
SALEM, OREGON

Application No. 46239  
Permit No. 34516

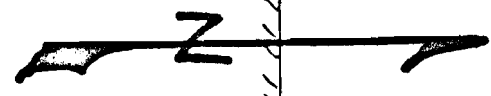

22  
23

15  
14

516

SW Cor. of Sec. 14 T. 12 S., R. 9 E. W.M.

← Boundary of Hatchery Property

Existing Ponds

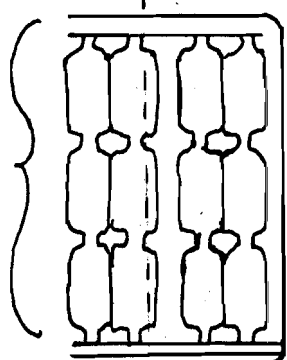

ROAD

Ditch

Approximate Location for experimental ponds

PIPE LINE

Drainage

WIZARD FALLS  
FISH HATCHERY  
Proposed pipe line and  
experimental pond  
Scale 1" = 100"  
Oregon State Game Comm.  
7/15/69

Metolius River

100'

Diversion Point

P# 34528  
34516