

G 5045

55009
39547

T. 4 N. R. 28 E. W. M.

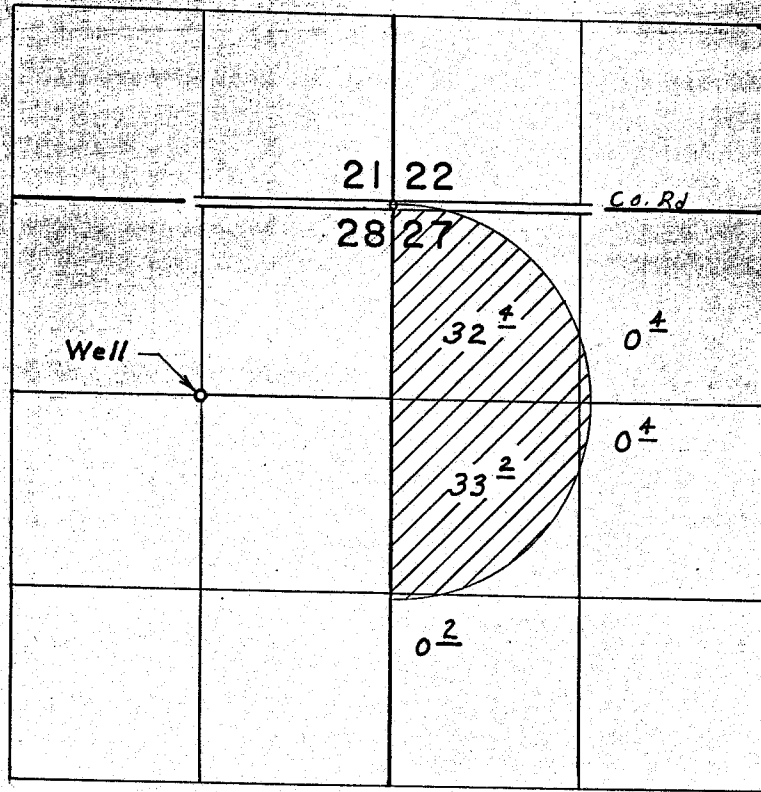

Well located 1300' S. & 1320' W. from N.E. Cor. Sec. 28

FINAL PROOF SURVEY UNDER

Application No. G-5599 Permit No. G-5045
IN NAME OF

LEONARD H. WILLIAMS

Surveyed June 26, 1971, by L. E. Gould