

T. 4 S., R. 3 W., W.M.

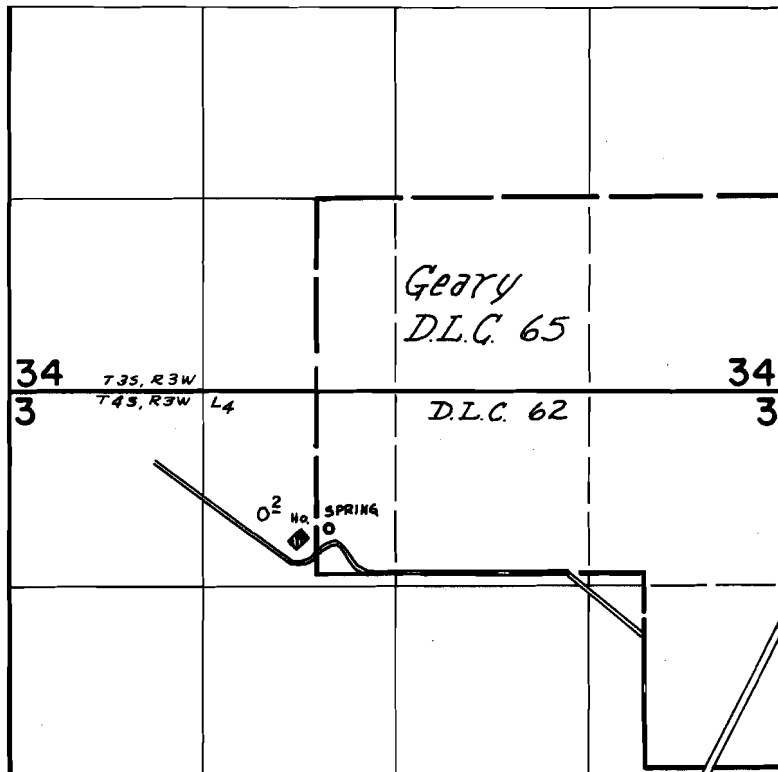

SPRING LOCATED: 310' N & 90' E FROM N'LY SW COR. GEARY DLC 62

FINAL PROOF SURVEY UNDER

Application No. 40712 Permit No. 30326
IN NAME OF

R. NORMAN & VERA W. & NORMAN B. FLEMING

Surveyed Oct. 25 1972, by D. Norby