

T.13S., R.33&34E., W.M.

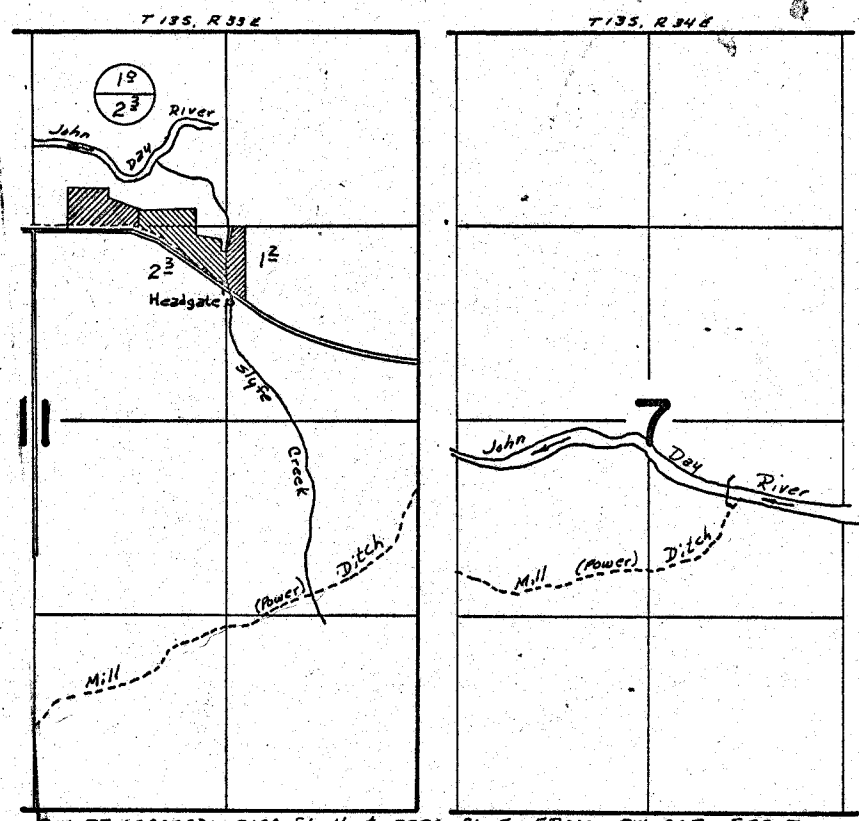

DIV. PT. LOCATED: 2180 FT. N & 3220 FT. E FROM SW COR. SEC 7.

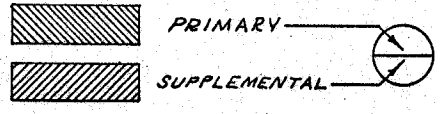

FINAL PROOF SURVEY UNDER

Application No. 40796 Permit No. 30630
IN NAME OF

ALVIA J. PICKLE

Surveyed Aug. 4 1972, by D. Norby