

T.13S., R.31E., W.M.

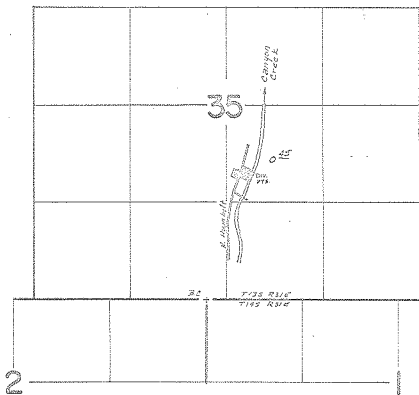

DIV. PTA. LOCATED: 1710' N & 610' E FROM NW COR. SEC. 1
1660' N & 590' E FROM NW COR. SEC. 1

FINAL PROOF SURVEY
UNDER

Application No. 43818 Permit No. 32759
IN NAME OF

FLOYD OFFICER

Surveyed July 13, 1972, by D. Norby