

# T.13S., R.31E., W.M.

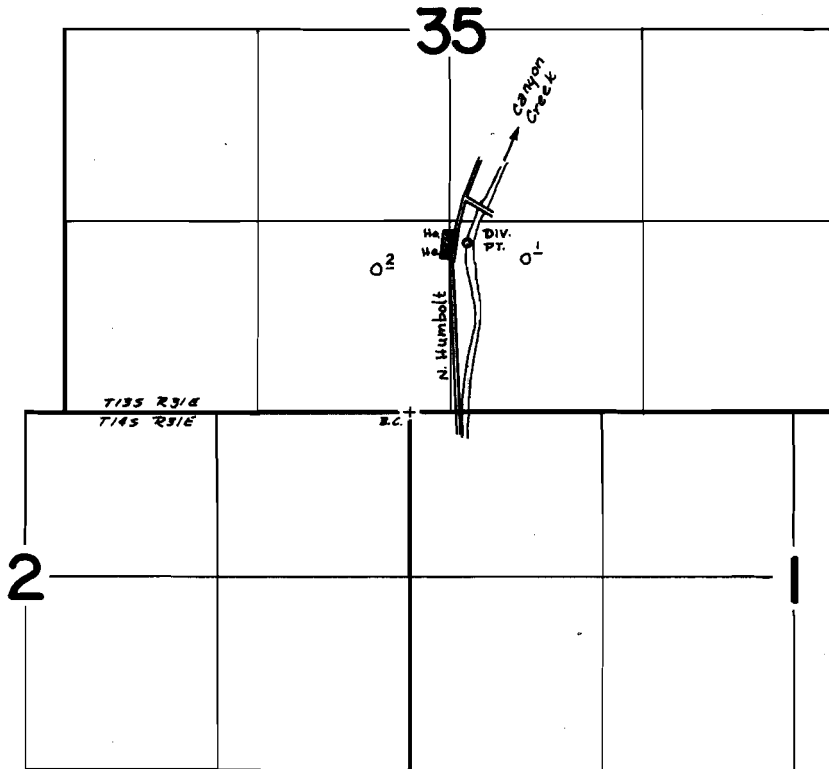

DIV. PT. LOCATED: 1160 FT. N & 410' E FROM NW COR. SEC 1

## FINAL PROOF SURVEY UNDER

Application No. 43865 Permit No. 32777  
IN NAME OF

HARRY R. PIERPONT

Surveyed July 13 1972, by D. Norby