

# T.7S. R.5&6W., W.M.

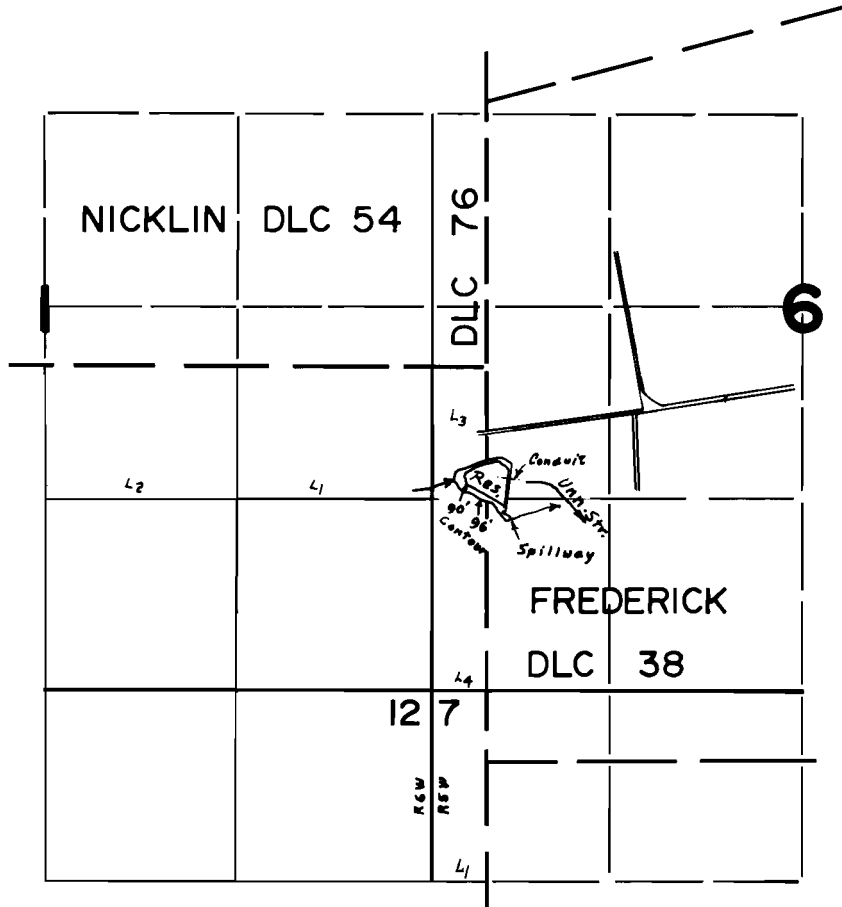

Dam loc. 760'S. & 150'E. From S.E. Cor. Nicklin DLC 76

## FINAL PROOF SURVEY UNDER

Application No. R-44099 Permit No. R-5089  
IN NAME OF

JOHN AEBI

Surveyed SEP. 1, 1972, by J.S. DONALDSON