

T. 9 S. R. 27 E. W. M.

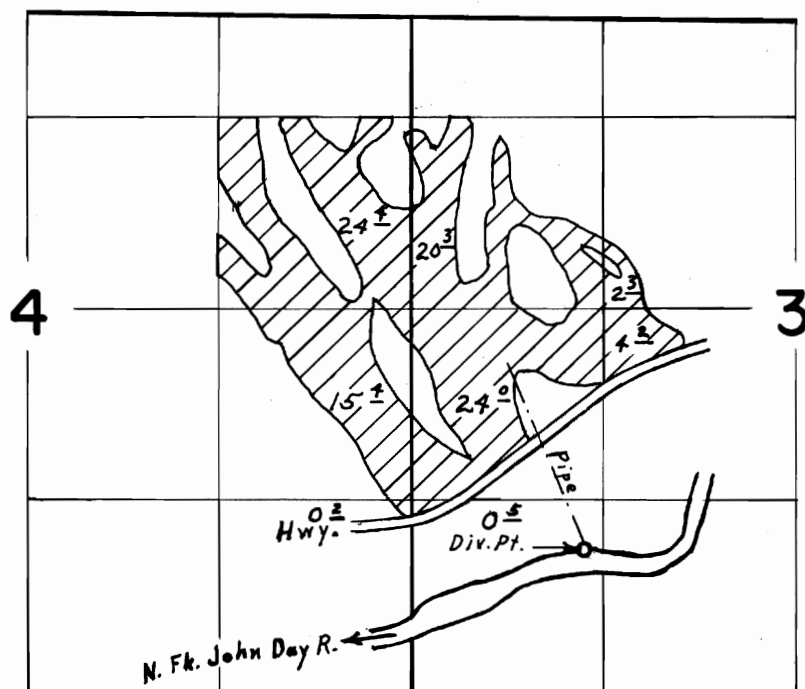

Div. Pt. located 3660' S. & 6460' E. from N.W. Cor. Sec. 4

FINAL PROOF SURVEY UNDER

Application No. 43391 Permit No. 32445
IN NAME OF

JAMES S. & DORIS TIPPETT

Surveyed Aug. 3, 1972, by L. E. Gould