

T. 23 S. R. 31 E. W. M.

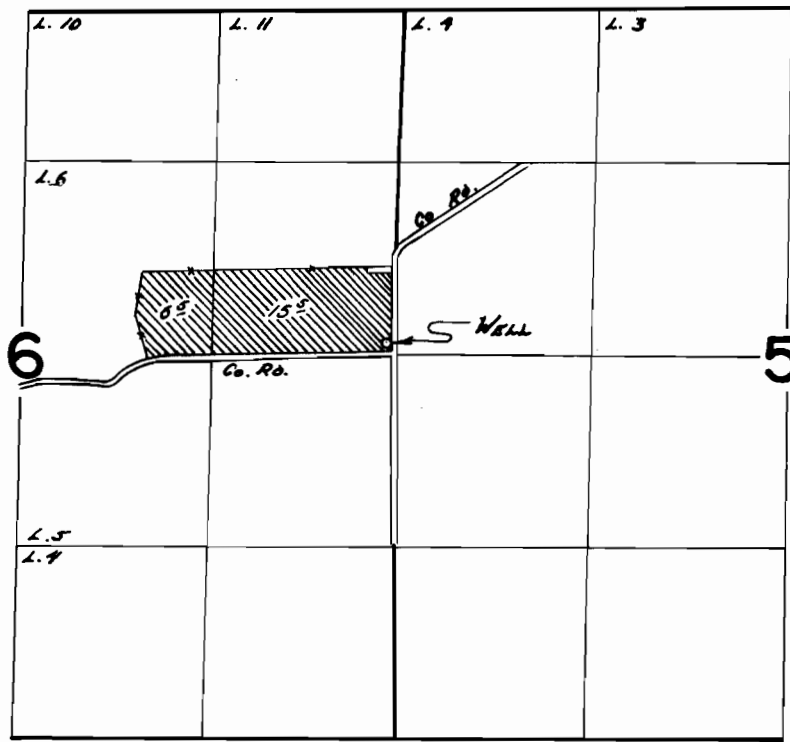

WELL LOC: 80' N & 30' W FROM E 1/4 COR SEC 6

FINAL PROOF SURVEY UNDER

Application No. G-3584 Permit No. G-3324
IN NAME OF

JAMES D. LANDON

Surveyed Aug. 24 1972, by R.G. MCKEN