

T. 23 S. R. 30 E. W.M

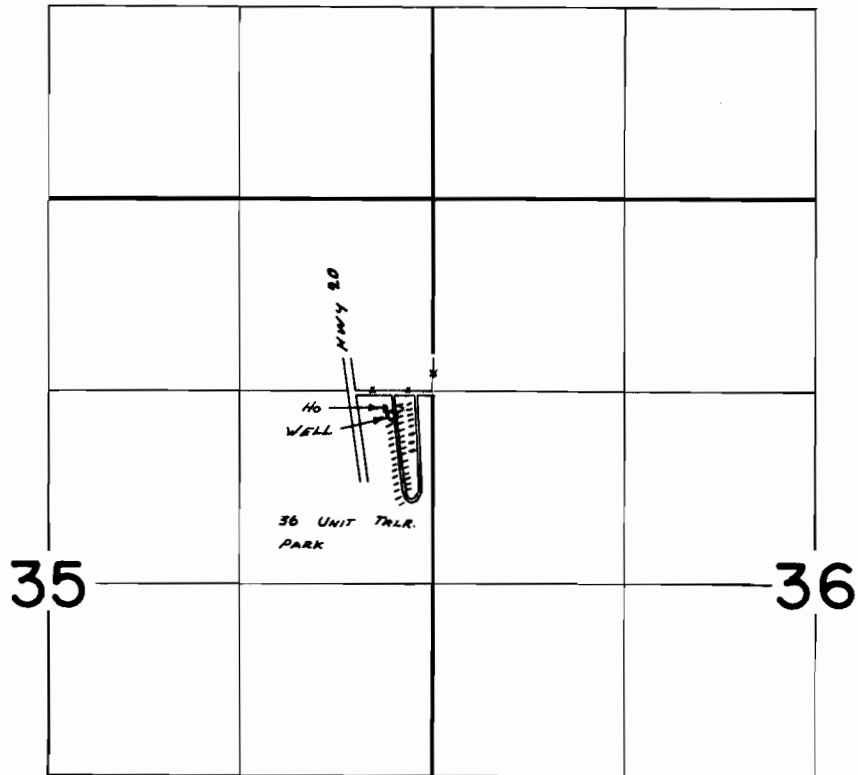

WELL Loc. 170' 6. E 280' W. FROM NE COR. SE 1/4 NE 1/4 SEC. 35

FINAL PROOF SURVEY
UNDER

Application No. G-4597 Permit No. G-4322
IN NAME OF

JOE N. MONROE & MARIAN H. MONROE

Surveyed Aug. 23 1972, by R. B. MURPHY