

T. 34S.R.6W.W.M.

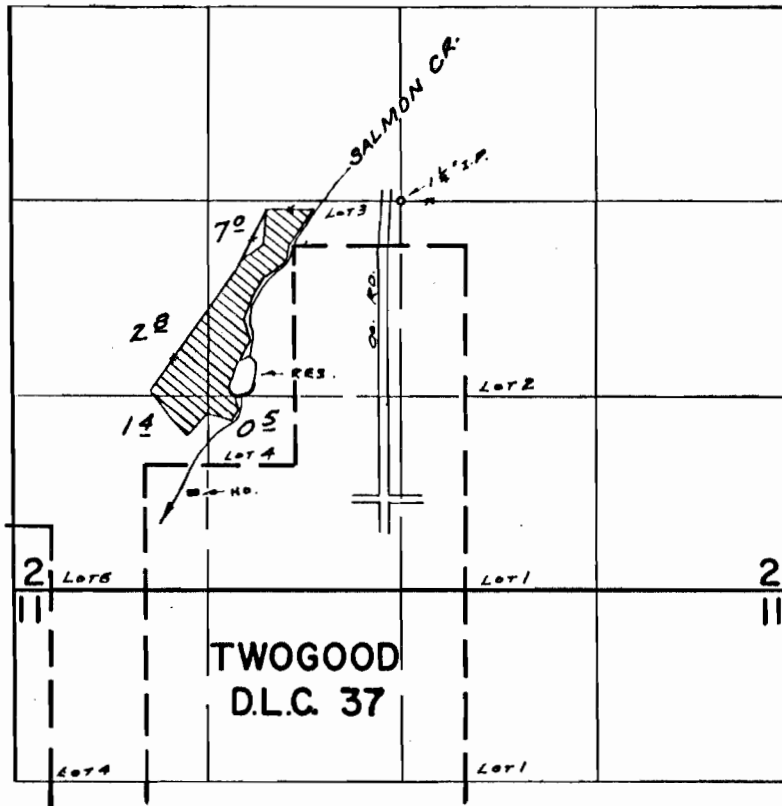

Div. Pt. Loc: 1070' W. & 1320' S. FROM CENTER SEC. 2

FINAL PROOF SURVEY UNDER

Application No. ^{R-41875} 41867 Permit No. ^{R-4702} 31188
IN NAME OF

WILLIAM P. ANGELI & GEORGE H. ANGELI

Surveyed APR. 15, 1970, by R. MUCKEN.