

# T.10S. R.3W. W.M.

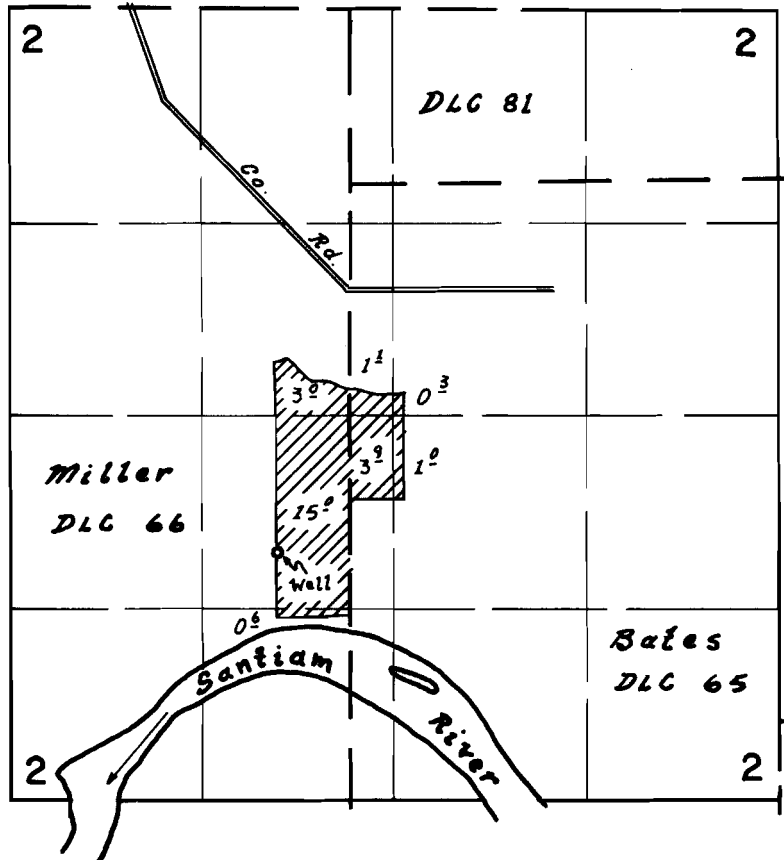

Well loc. 2550' S. & 500' W. from N.W. cor. Bates DLC 65

## FINAL PROOF SURVEY UNDER

Application No. ~~G-4106~~ Permit No. ~~G-3854~~  
IN NAME OF

Eugene M. & Marjorie L. Powell

Surveyed 18 OCT 1972 by D. O'Reilly