

# T. 5 S. R. 2 W. W.M.

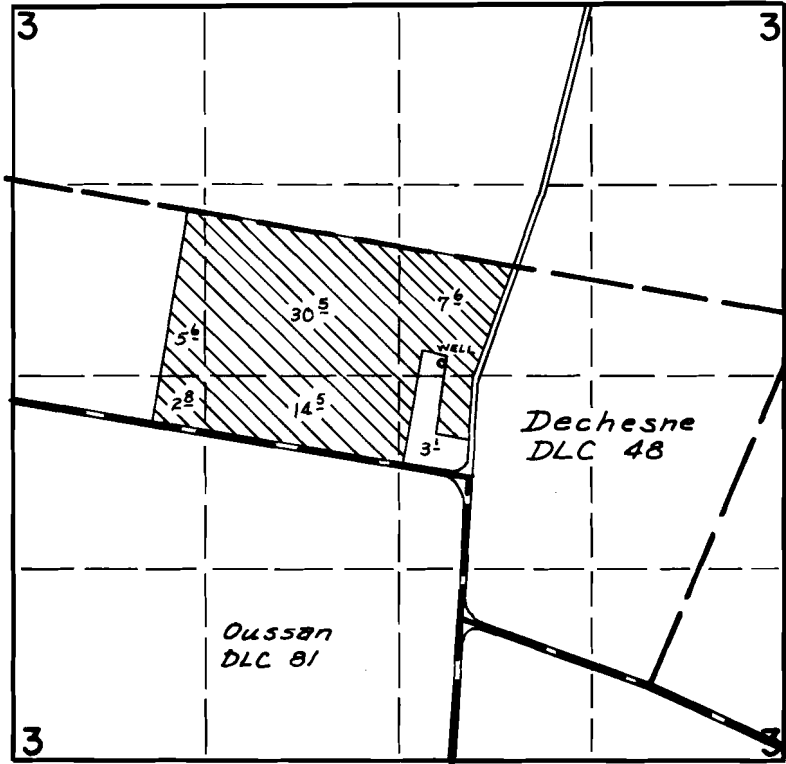

WELL LOCATED: 790' S & 200' W FROM NE COR OUSSAN DLC 81

## FINAL PROOF SURVEY UNDER

Application No. G-4210 Permit No. G-3974  
IN NAME OF

WOODBURN FEED and SUPPLY, INC.

Surveyed Sept 22 19 72, by D. Norby