

T. 5 S. R. 2 W. W.M.

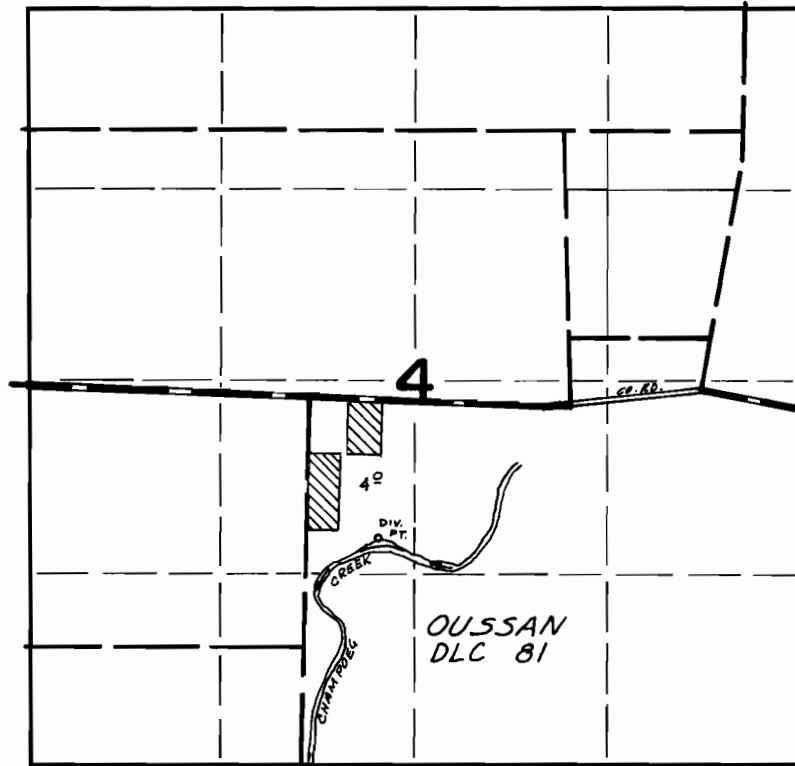

DIV. PT. LOCATED: 970'S & 970'E FROM NW COR OUSSAN DLC 81

**FINAL PROOF SURVEY**  
UNDER

Application No. 44871 Permit No. 33551  
IN NAME OF

JOHN M. SCHUETZ

Surveyed Sept 22 1972, by D. Norby