

2900

T. 7 S. R. 1 W. W.M.

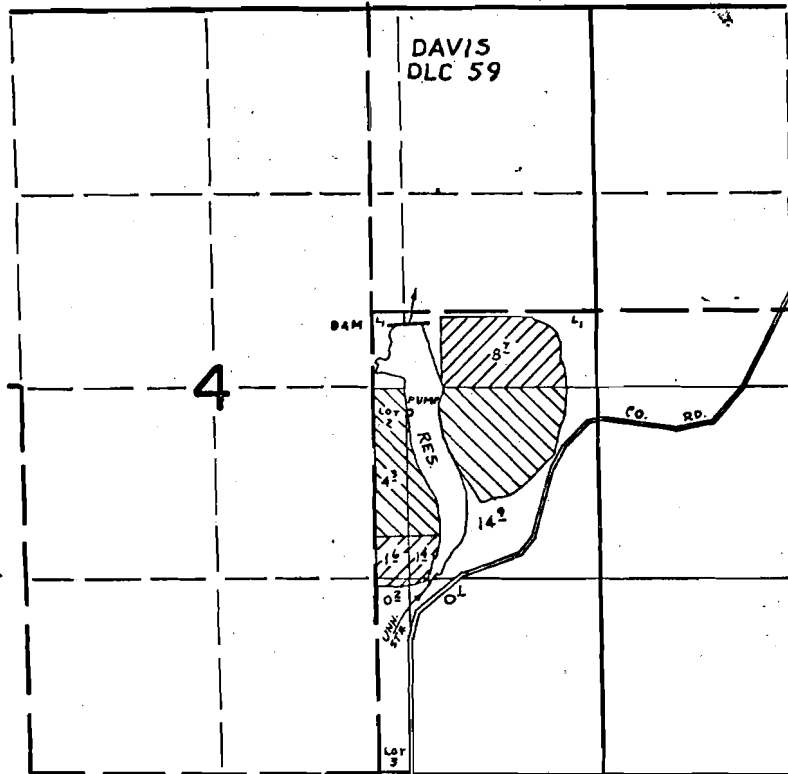

DIV. PT. LOCATED: 70'S AND 250' E FROM SW COR. DAVIS DLC 59



FINAL PROOF SURVEY UNDER

Application No. R-41996 41927 Permit No. R-4851 31934
 IN NAME OF

NORMAN STADELI

Surveyed APRIL 19 1972, by D. NORBY