

TOWNSHIP 1 N., RANGE 20 E

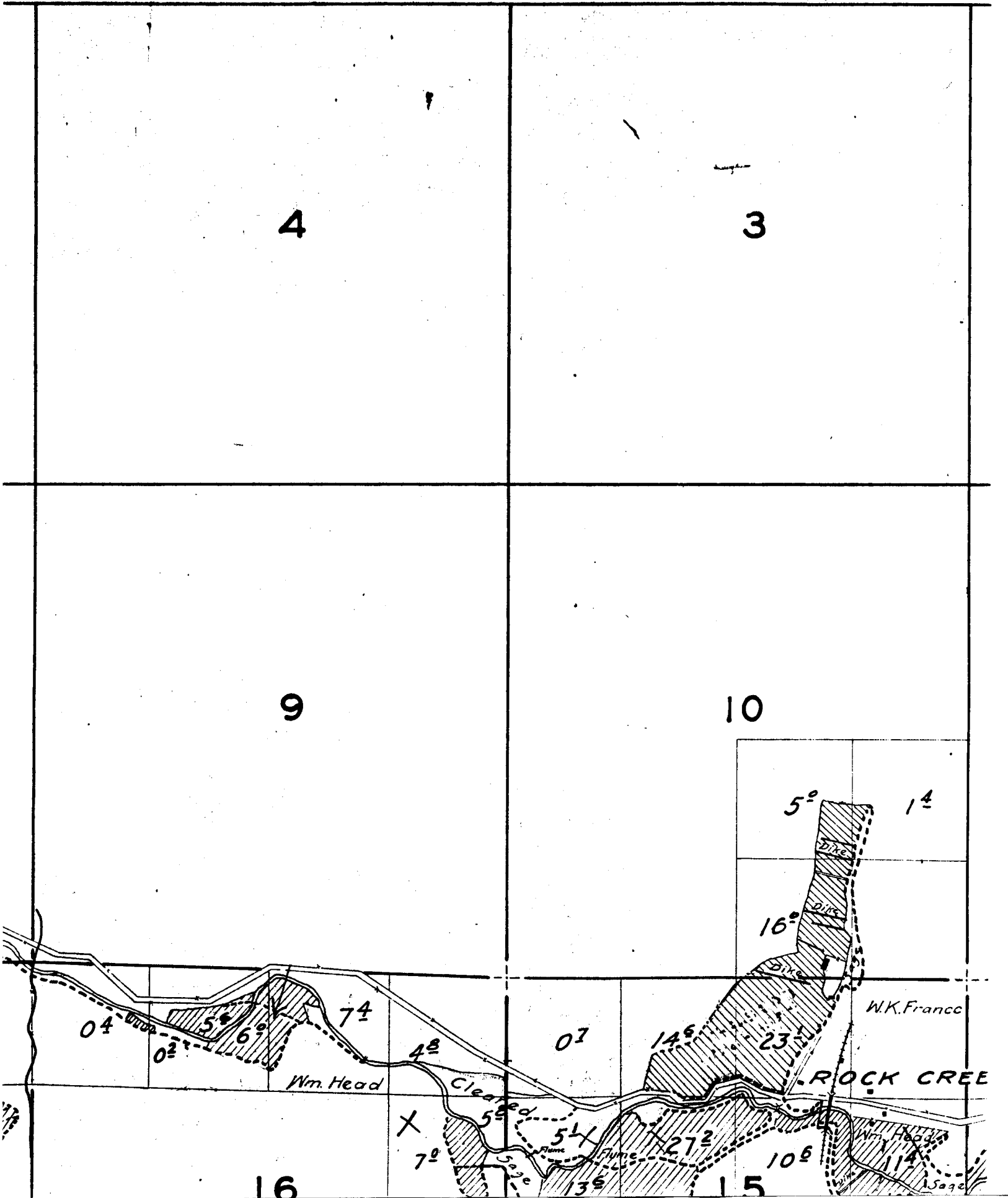

ANGE 20 E.

4-2-1

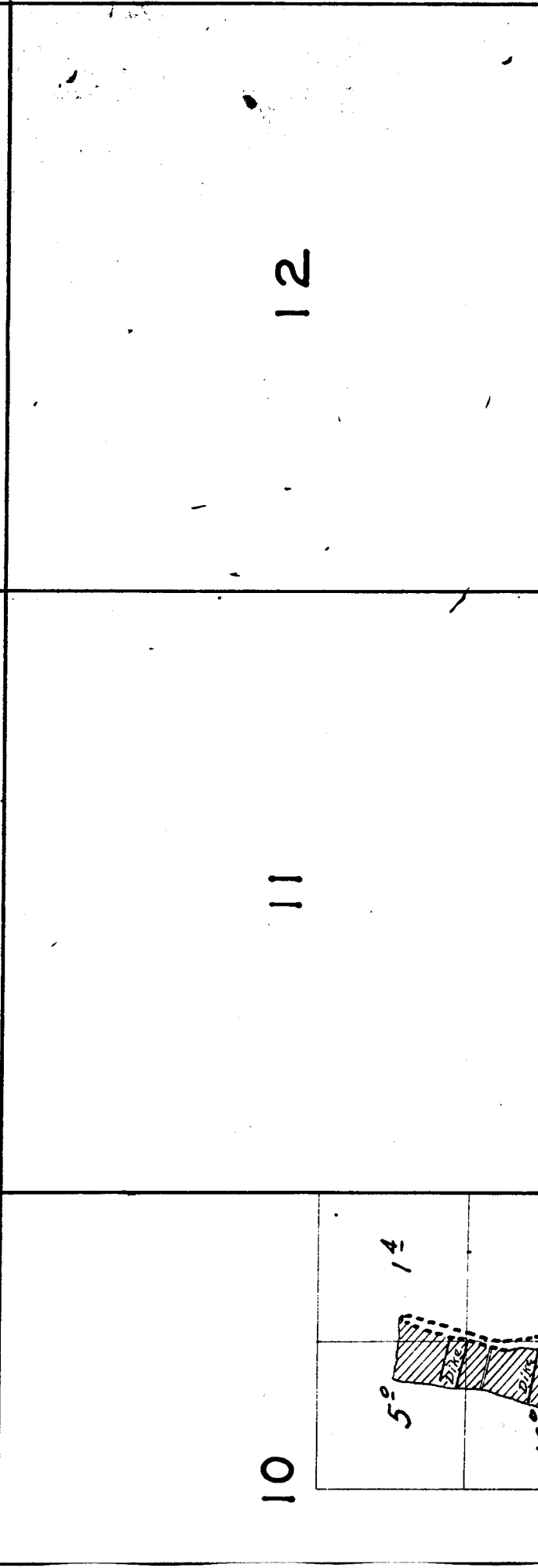
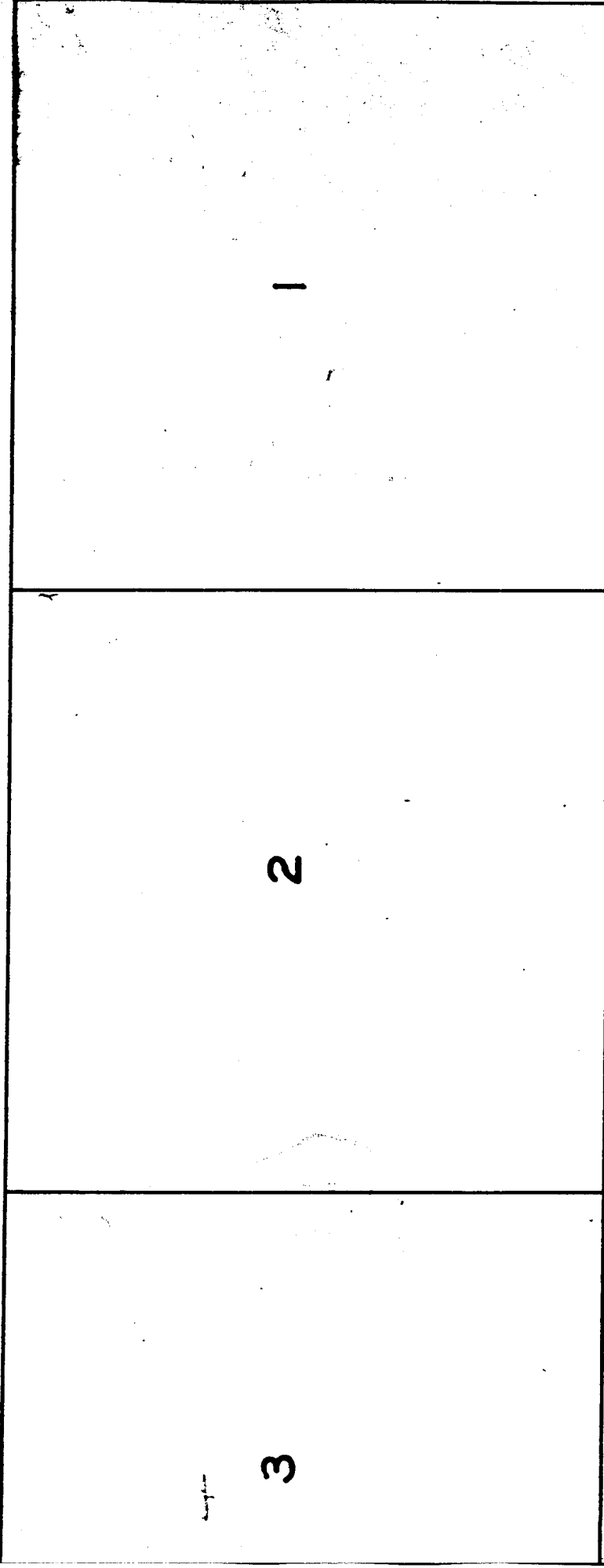

23

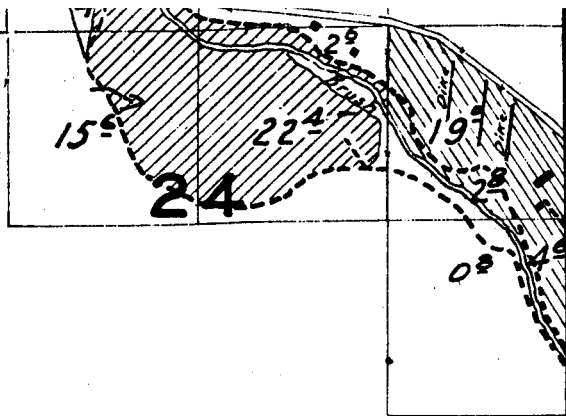

26



25

35

36

19

20

30

29



31

32

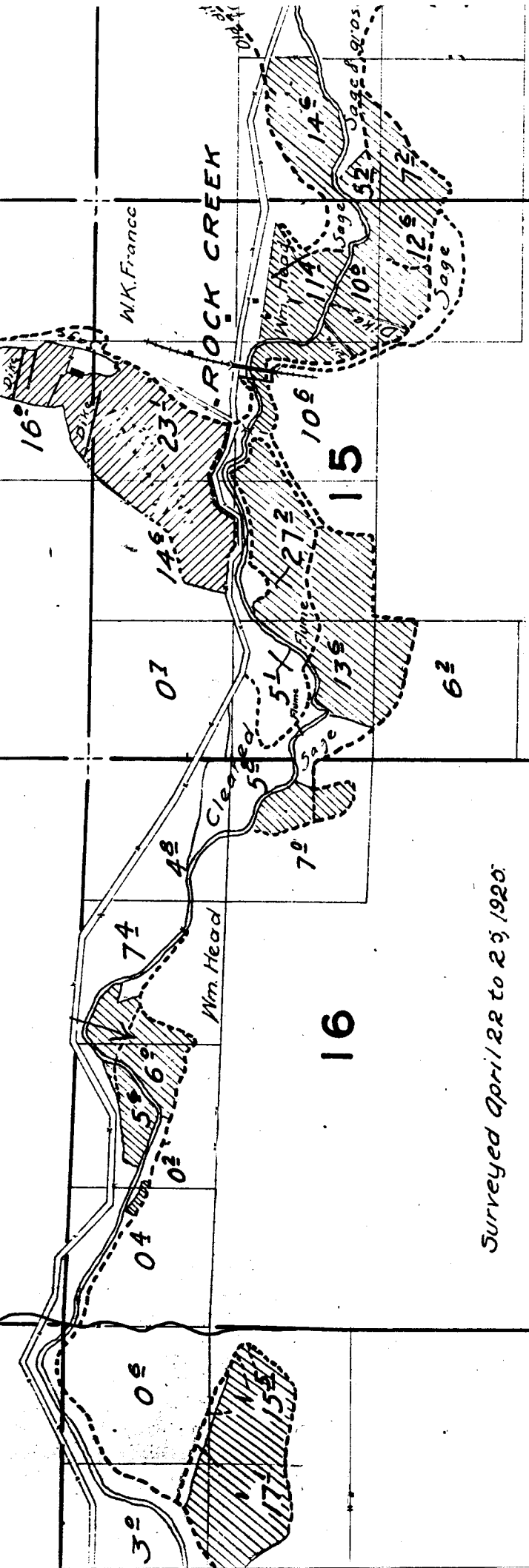

Surveyed April 22 to 23 1920

21

Note:
Streams and roads, except in the vicinity of irrigated land, are sketched in approximate location.

22

28

27

33

34

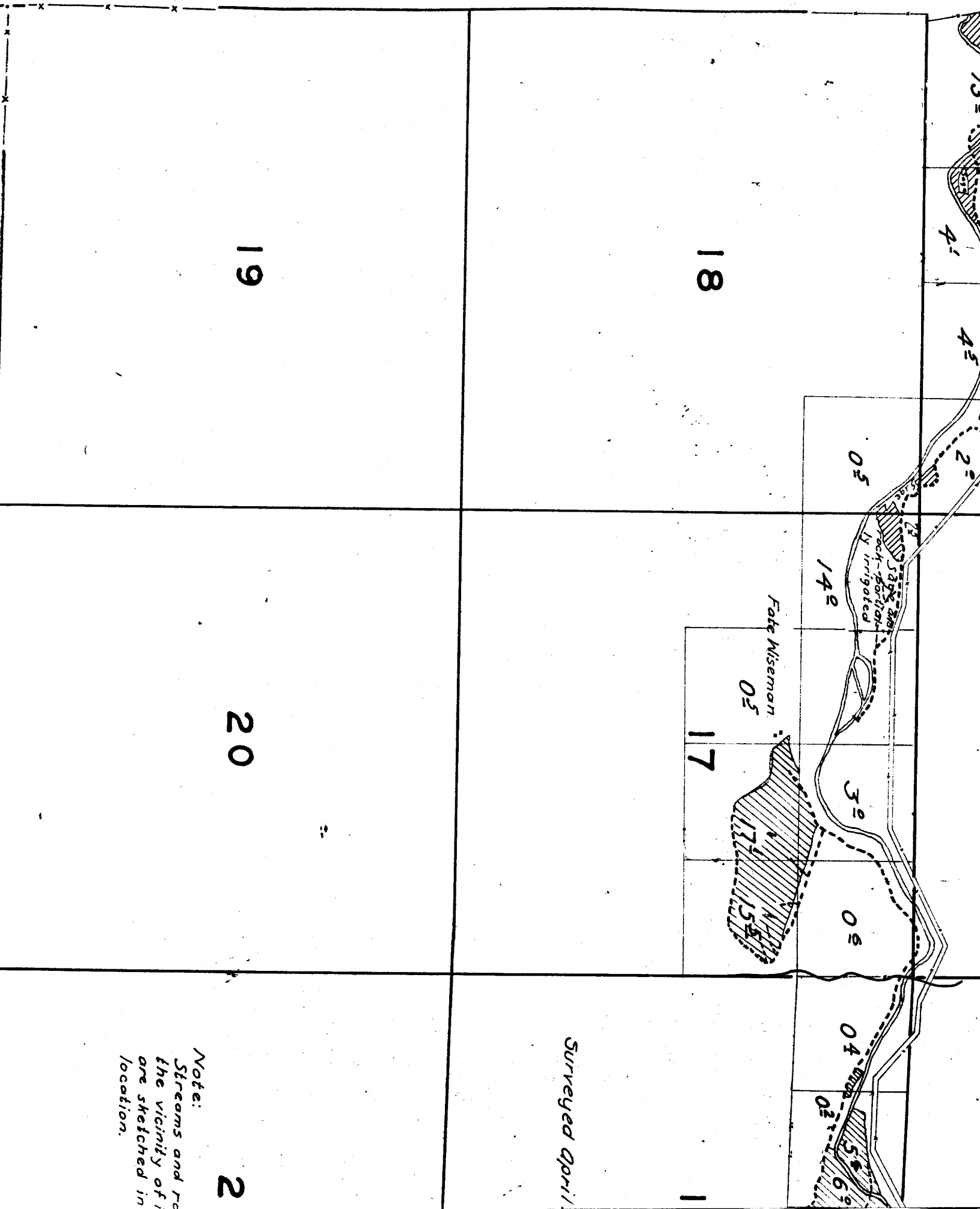

19

18

20

17

Surveyed April

Note:
Streams and roads
in the vicinity of
are sketched in
location.

2

TOWNS

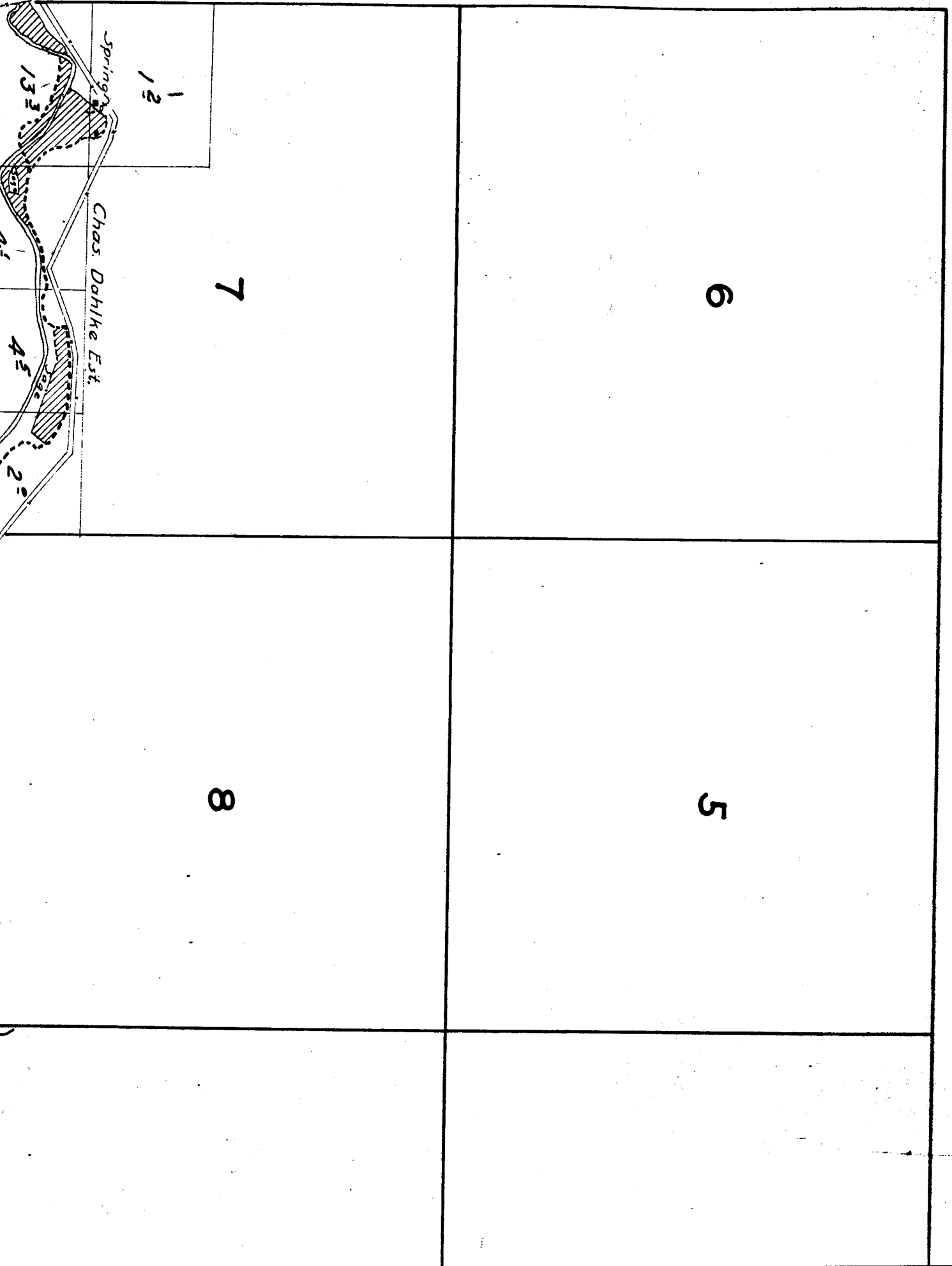

TOWNSHIP 1 N., RANGE 21 E.

4

3

9

10

16

15

23

24

26

25

35

36

15

14

13

22

23

24

3	2	1
10	11	12

19

20

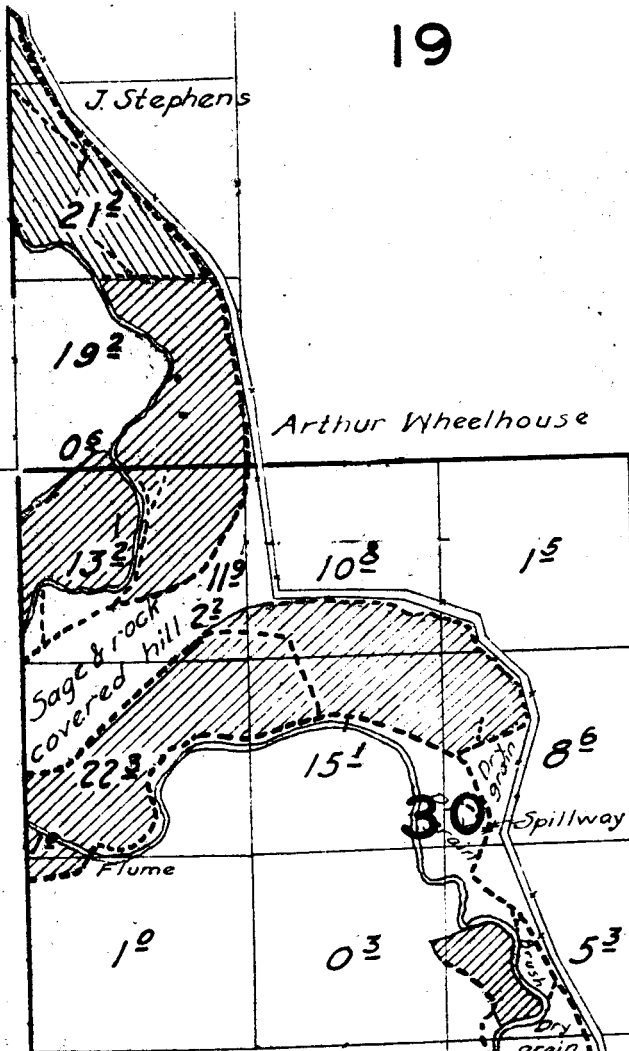

29

Note:

Streams and roads, except in the vicinity of irrigated land, are sketched in approximate location.

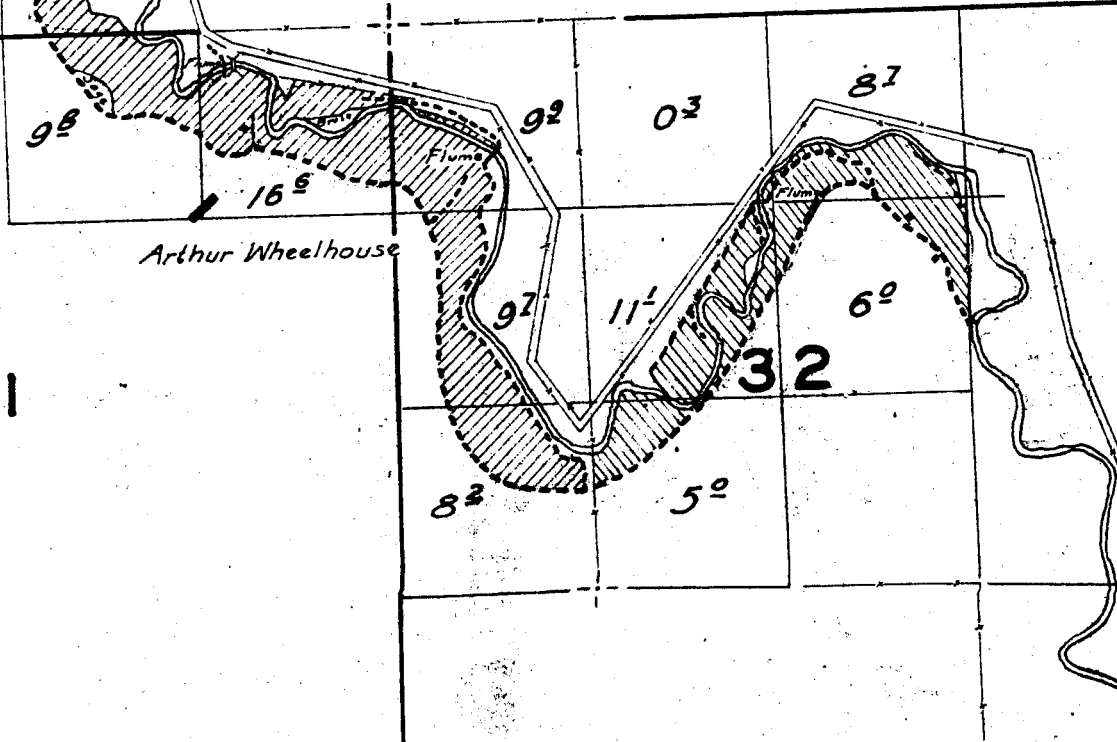

31

32

17

16

15

20

21

22

29

roads, except in
of irrigated land,
d in approximate

28

27

Surveyed April 28 and 29, 1925.

32

187

169

33

53

43

73

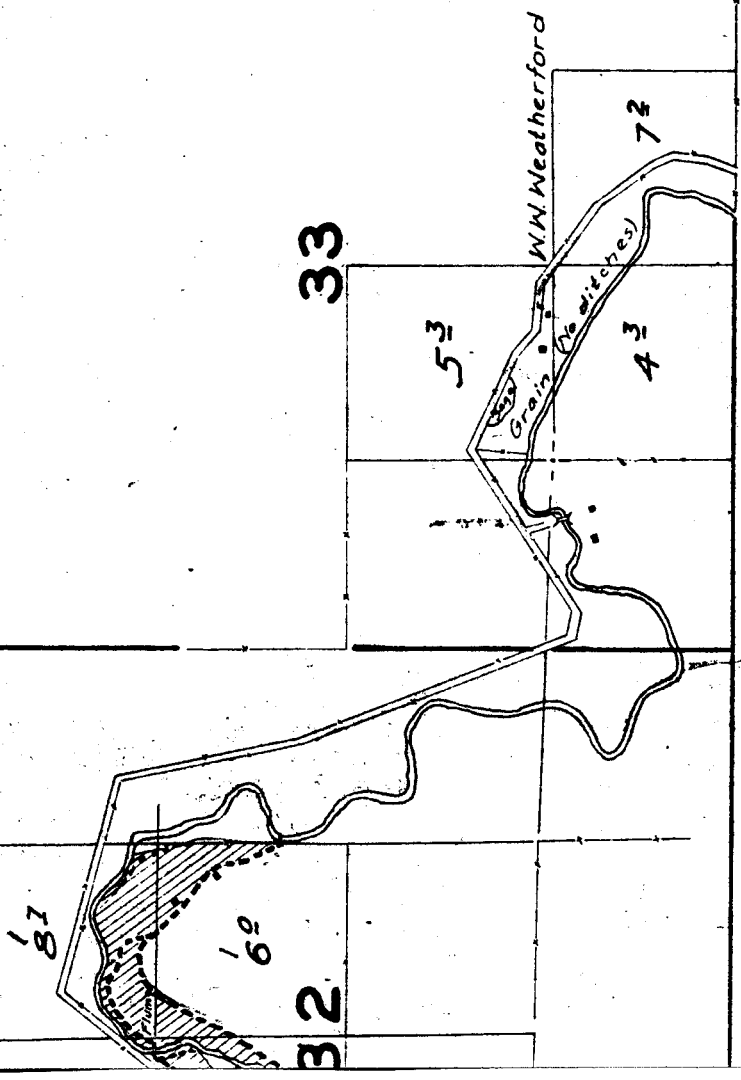

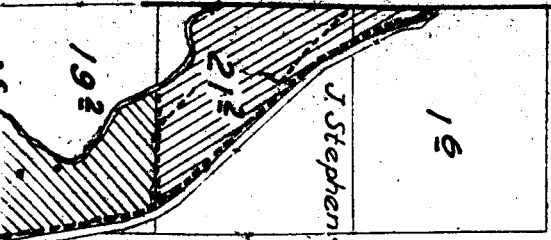

Arthur Winehouse

19

20

21

18

17

16

TOWNSHIP

6

5

4

7

8

9