

Permit: G 4488
 Volume: 5
 Strm: 2 WELLS>UNN STR
 Trib: JUMPOFF JOE CR
 Priority: 1/15/69

T.35S.R.6W.W.M.

RECEIVED

DEC 13 1974

WM. DIST. 14
 GRANTS PASS, ORE

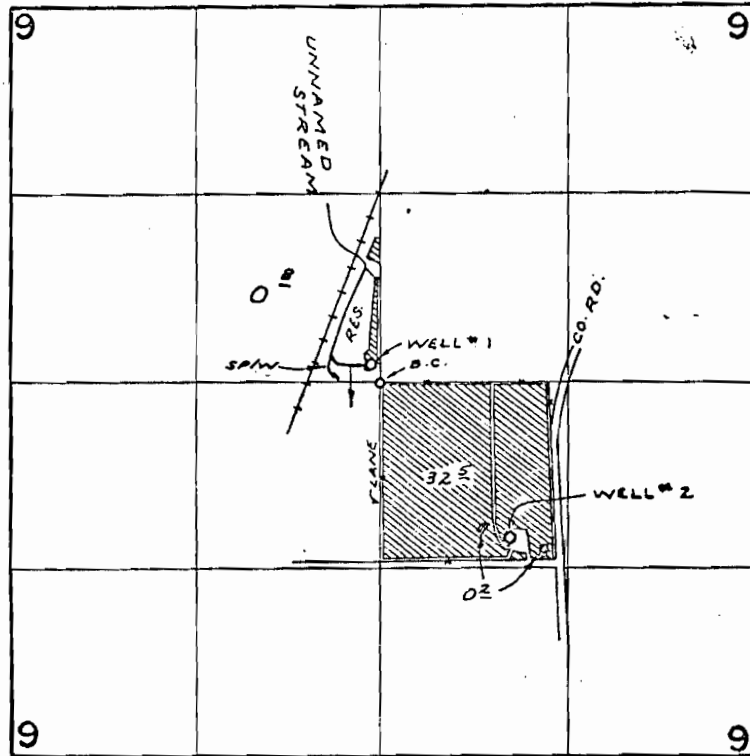

DIV. PTS LOC: WELL #1 - 120' N. & 10' W.; WELL #2 - 1100' S. & 930' E.
 STREAM - 120' N. & 220' W., ALL FROM GEN. SEC. 9

WELL #1 RES → [diagonal hatching] WELL #2 → [diagonal hatching]

FINAL PROOF SURVEY

UNDER

R-44177
 44178
 R-45707
 45708

R-5104
 33008
 R-5413
 34095

Application No. G-4269 Permit No. G-4488

IN NAME OF

BUREAU OF LAND MANAGEMENT

Surveyed APR. 17, 1972, by R. MUCKEN