

# T. 10S. R. 3W. W.M.

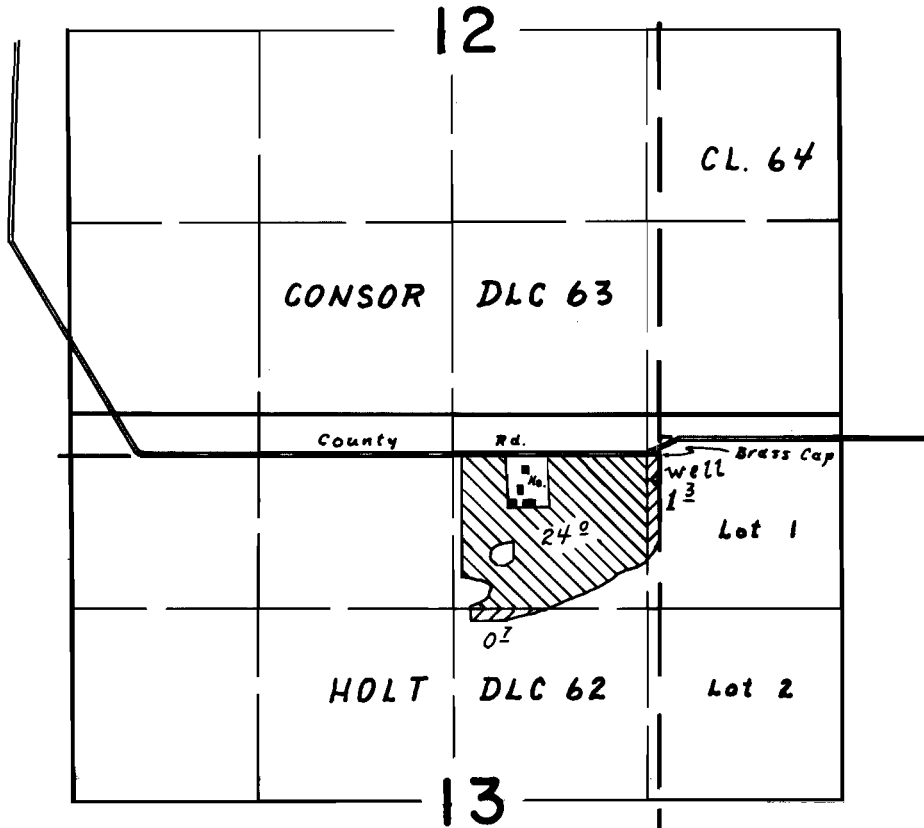

Well is loc. 175' S. & 12' W. from NE Cor. Holt DLC. 62

## FINAL PROOF SURVEY UNDER

Application No. G-4175 Permit No. G-3924  
IN NAME OF

Larry W. Wells

Surveyed 19 OCT 1972, by D. O'Reilly