

# T.4 S., R.2 W., W.M.

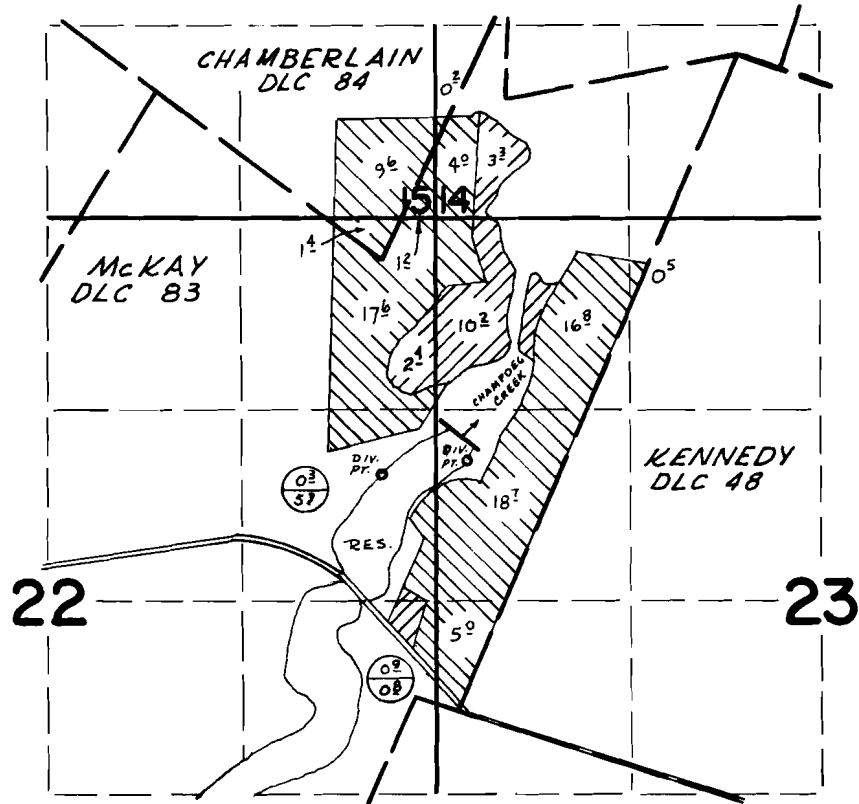

DIV. PTS. LOCATED: 1710' N & 60' E AND 1670' N & 520' W FROM SW COR. KENNEDY DLC 48.



## FINAL PROOF SURVEY UNDER

Application No. 45/66 Permit No. 33745  
IN NAME OF

A & R SPADA FARMS

Surveyed Oct 1972, by D. Norby