

T.7S. R.1W. W.M.

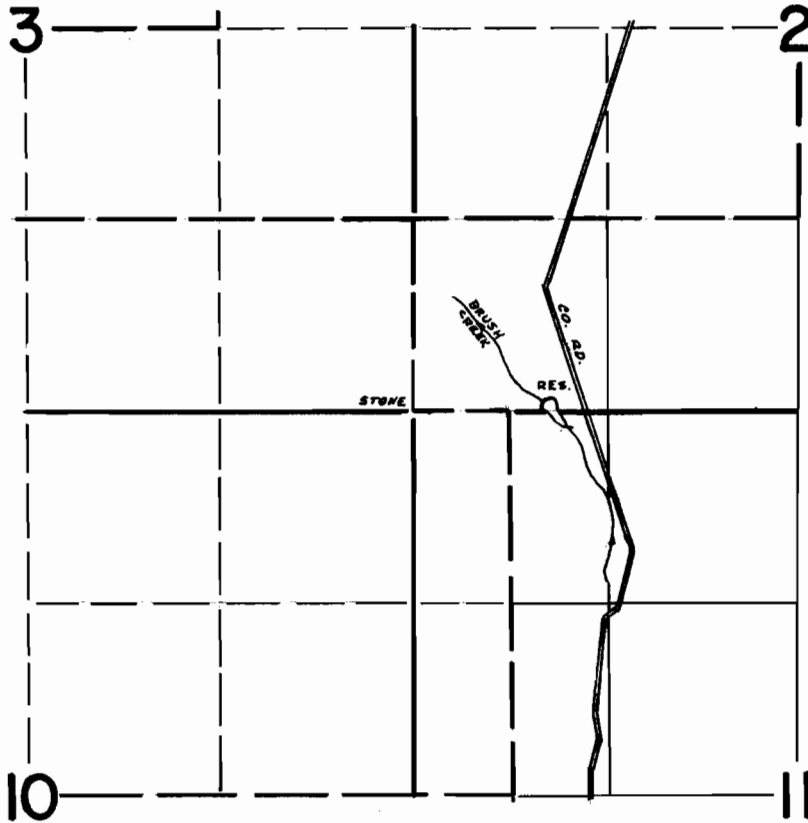

DIV. PT. LOCATED: 60' N & 800' E FROM SW COR SEC. 2

FINAL PROOF SURVEY UNDER

Application No. ^{R-44599} 44600 Permit No. ^{R-5282} 33921
IN NAME OF

NORMAN QUALEY

Surveyed APRIL 19 1972, by D. NORBY