

T.29S.R.5W.W.M.

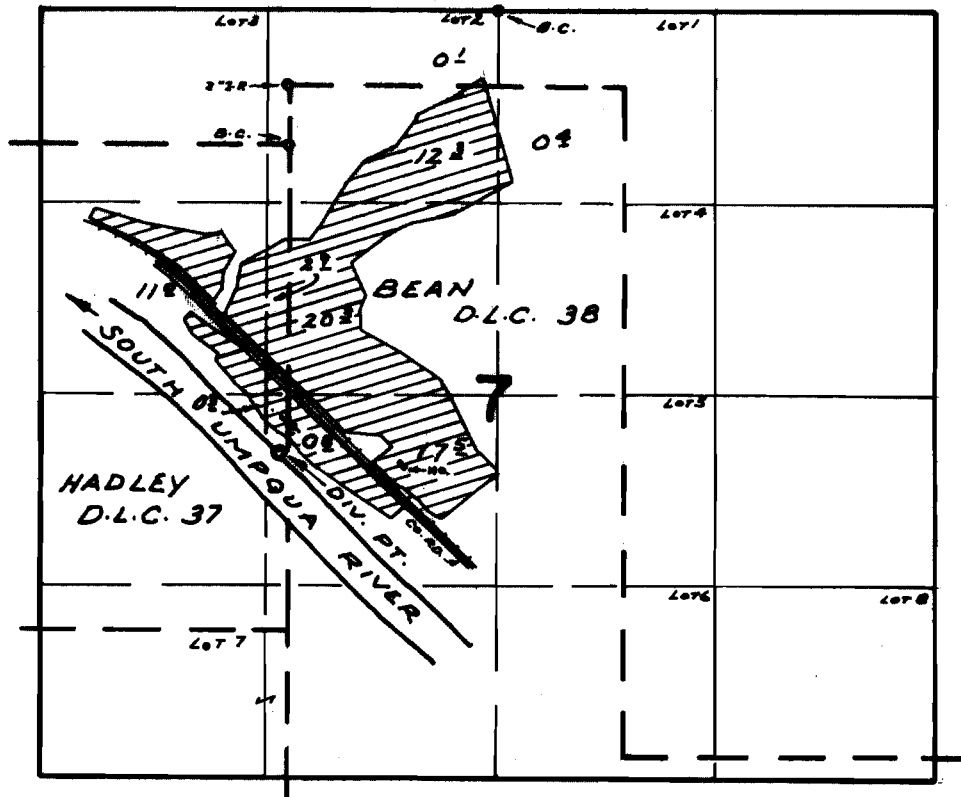

DIV. PT. LOC: 2120' S. & 60' W. FROM N.E. COR. HADLEY D.L.C. 37

FINAL PROOF SURVEY
UNDER

Application No. 46227... Permit No. 34537
IN NAME OF

KENNETH R. & GLENNA M. BARE

Surveyed MAY 8, 1972, by R. MUCKEN