

# T.27S.R.4W.W.M.

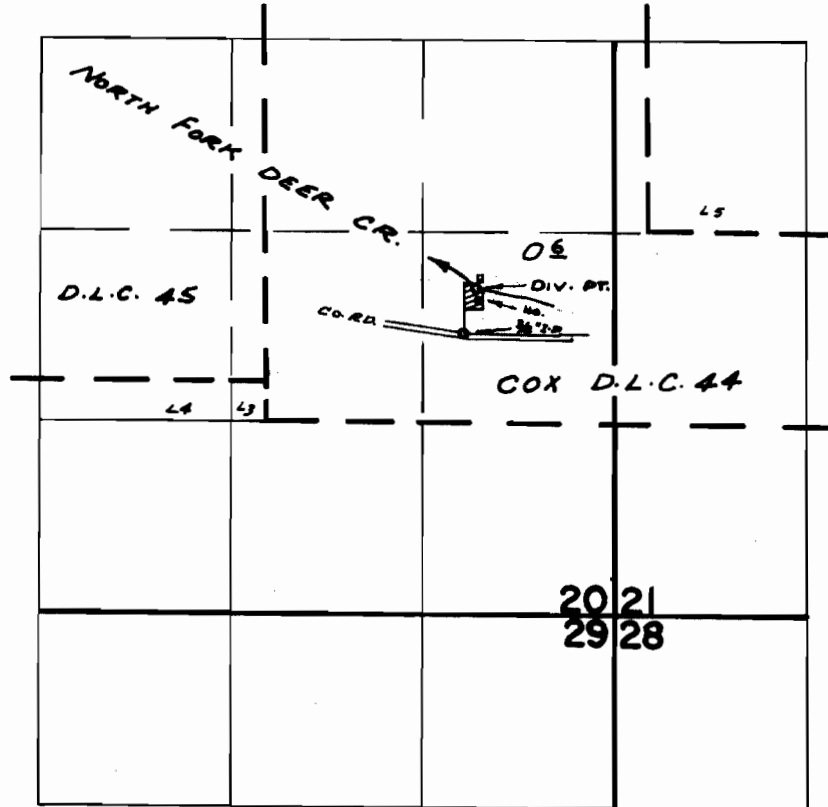

DIV. PT. LOC: 920' N. & 1450' E. FROM S.W. COR. D.L.C. 44

## FINAL PROOF SURVEY UNDER

Application No. 45275 Permit No. 33809  
IN NAME OF

CARL LEE MASON

Surveyed MAY 2, 1972, by R. MUCKEN