

T.33 S., R.6 W., W.M.

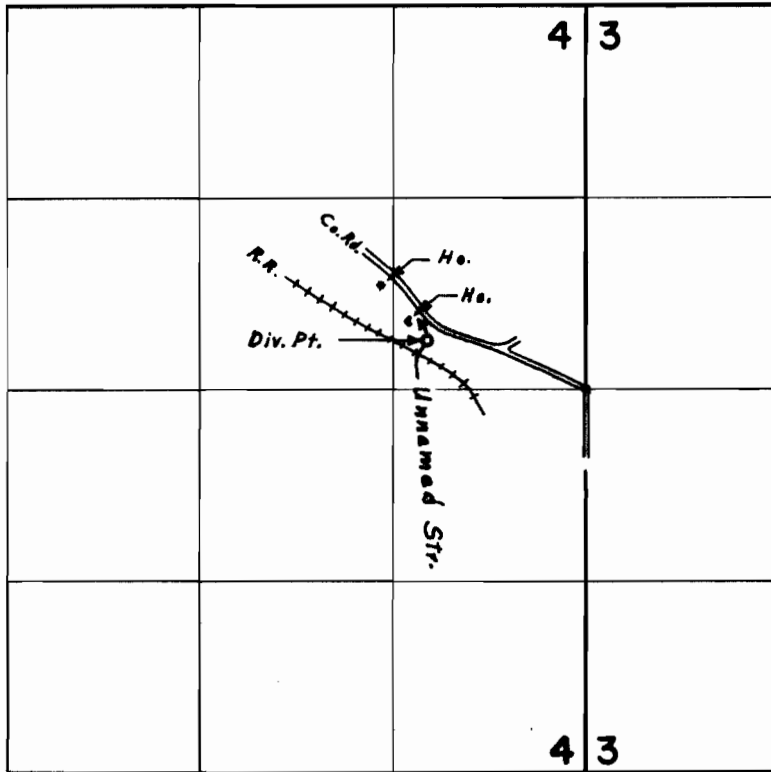

*Div. Pt. located 330' N. & 1080' W. from E. & Cor. Sec. 4*

**FINAL PROOF SURVEY**  
UNDER

Application No. 47733 Permit No. 35755  
IN NAME OF

WALLACE J. RONDEAU

Surveyed Aug. 22, 1972., by L. E. Gould