

T.22S., R.6W. W.M.

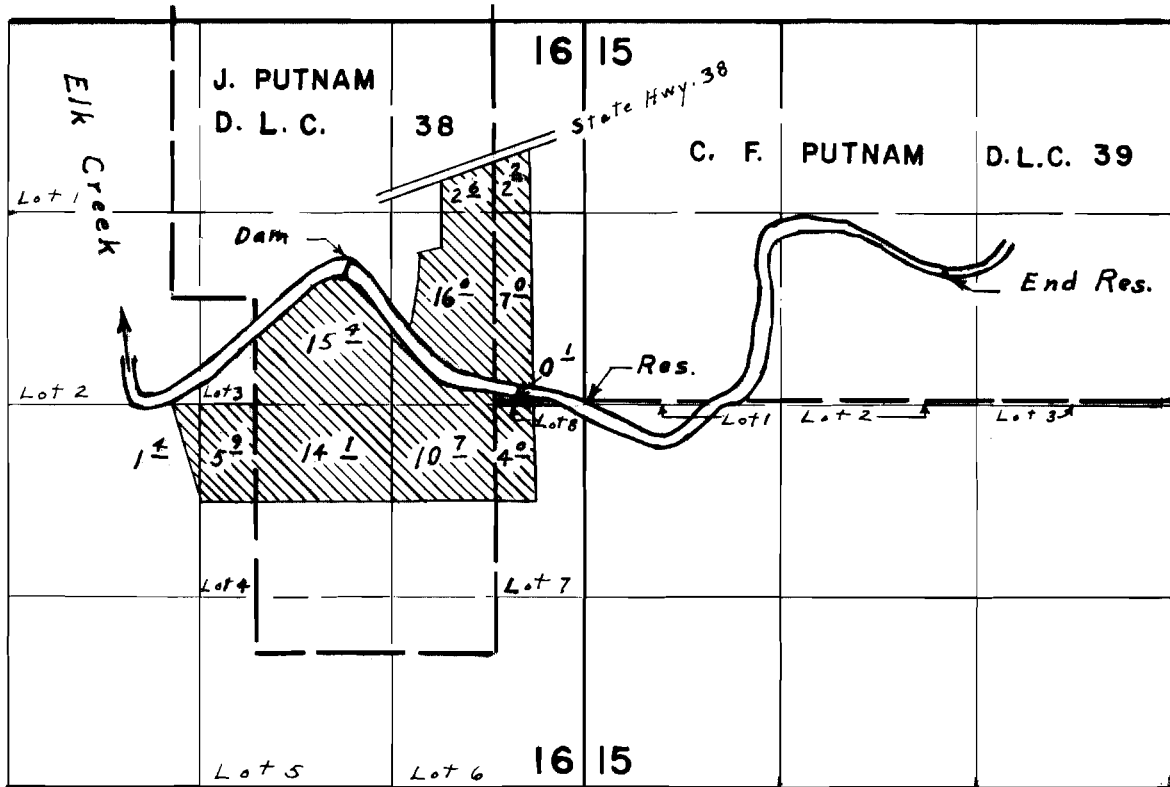

Div. Pt. located 940' N. E 1630' W. from E. $\frac{1}{4}$ Corner Section 16

FINAL PROOF SURVEY UNDER

R-43912 R-5052
Application No. 43913 Permit No. 32819
IN NAME OF

BRUCE CUNNINGHAM

Surveyed May 4, 1972, by L. E. Gould.