

# T. 7 S. R. 1 W. W.M.

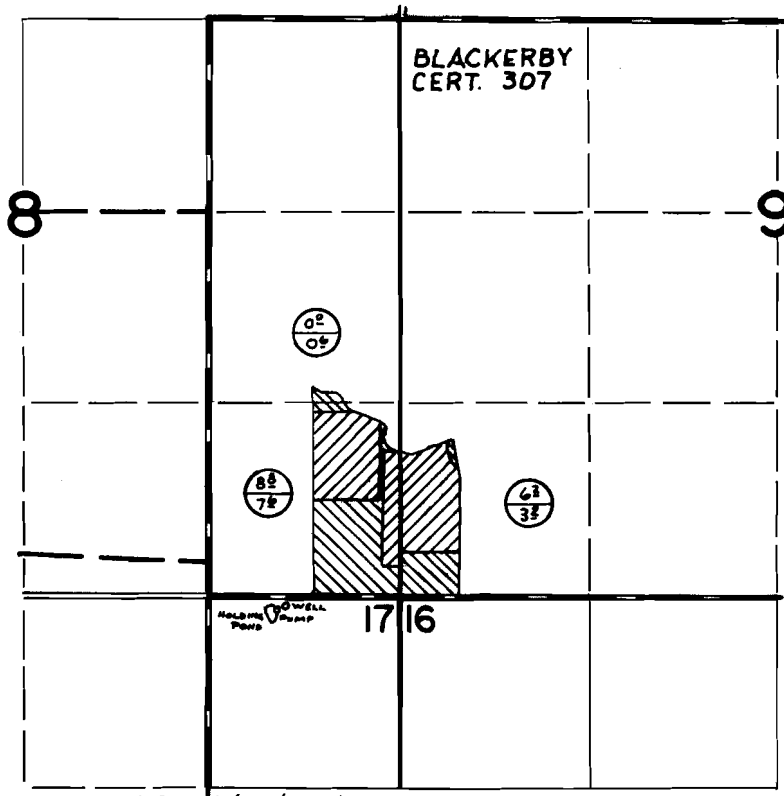

WELL LOCATED: 60' S & 780' W FROM SE COR SEC 8

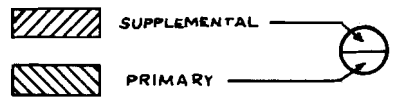

## FINAL PROOF SURVEY UNDER

Application No. G-4199 Permit No. G-3921  
IN NAME OF

ARTHUR A. KUENZI

Surveyed APRIL 26 1972, by D. NORBY