

# T.6S. R.1W. W.M.

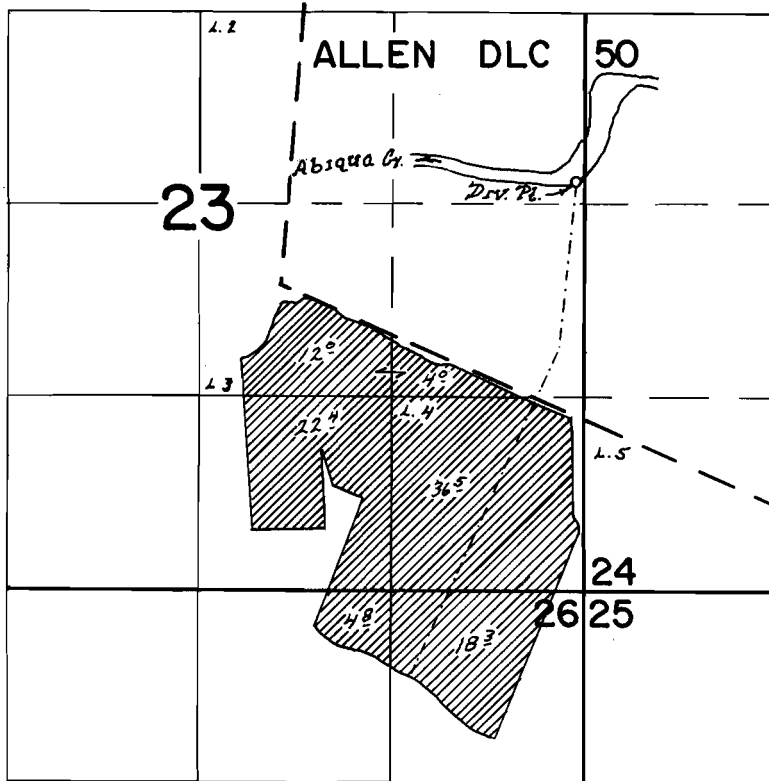

Div. Pl. Loc: 2830' N & 50' W From SE Cor Sec. 23

## FINAL PROOF SURVEY UNDER

Application No. 44388 Permit No. 33157  
IN NAME OF

HERMAN GOSCHIE

Surveyed June 14 1972, by R. B. Mucken