

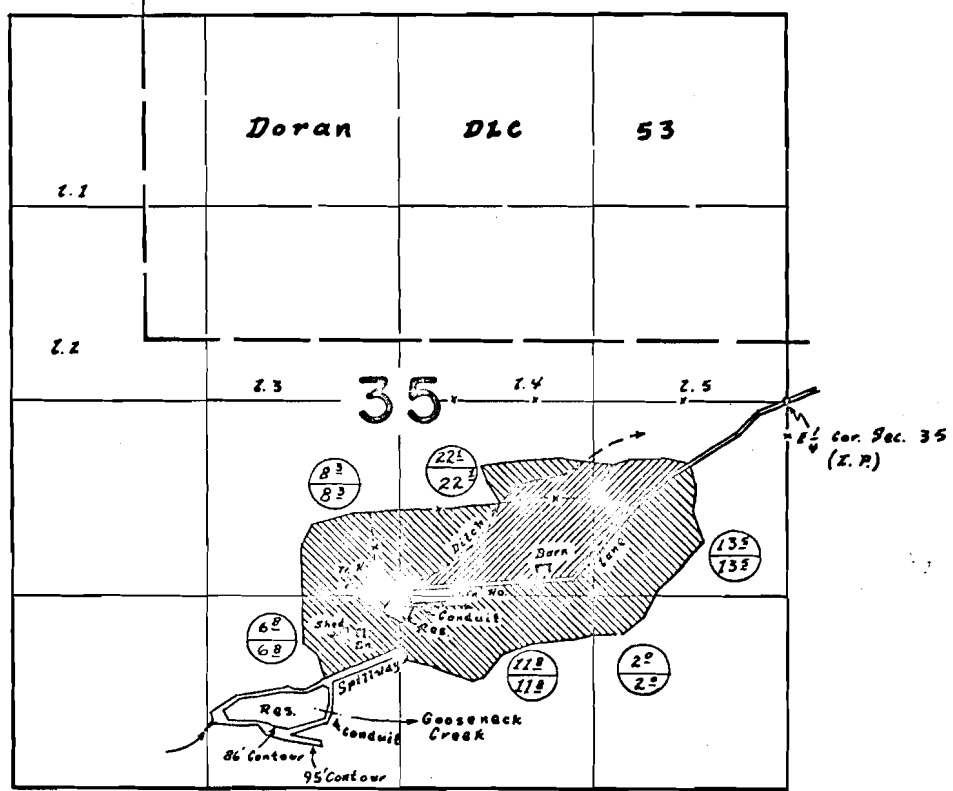



T. 6 S. R. 7 W. W.M.



Upper Reservoir 1420'S. x 2560' W. } All loc. from E. 1/4 Cor. Sec. 35
 Lower Reservoir 2140'S. x 3100' W. }

Flooded  Primary 
 Sprinkled  Supplemental 

FINAL PROOF SURVEY

UNDER

| | |
|---------|--------|
| R-38860 | R-3418 |
| 38861 | 28946 |
| R-41412 | R-4592 |
| 41422 | 30517 |
| R-43211 | R-4840 |

Application No. 43212 Permit No. 31865

IN NAME OF

Frank F. & Alice I. Propes

Surveyed 31 Aug. 1972, by L.E. Gould