

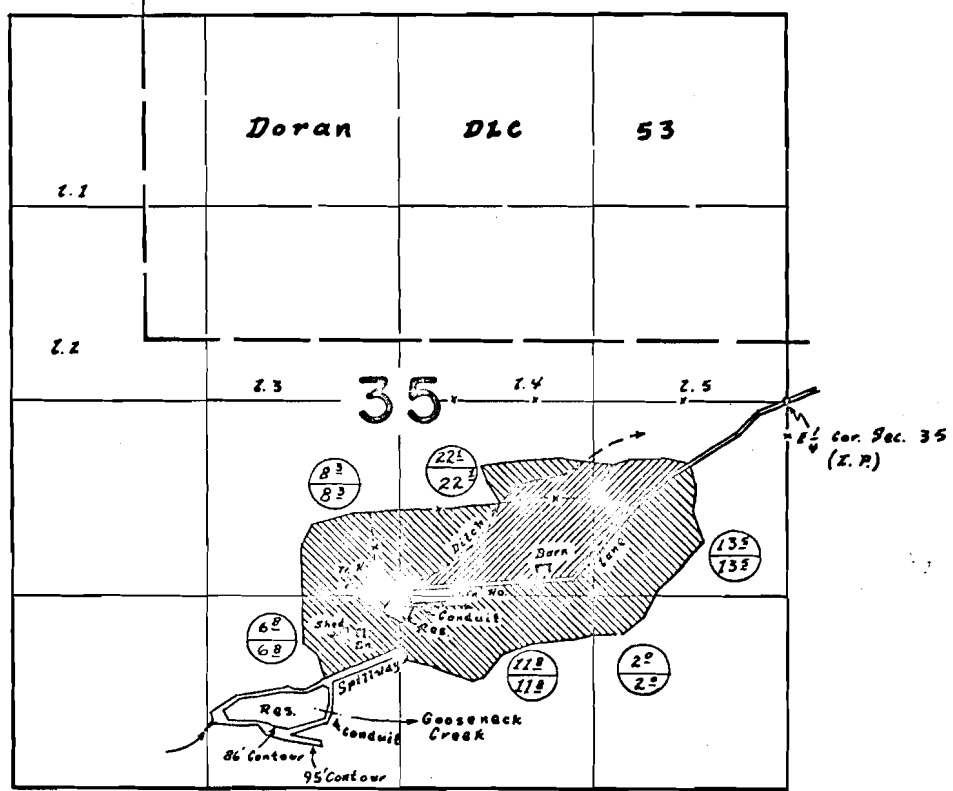



T. 6 S. R. 7 W. W.M.



Upper Reservoir 1420'S. x 2560' W. } All loc. from E. 1/4 Cor. Sec. 35
 Lower Reservoir 2140'S. x 3100' W. }

Flooded  Primary 
 Sprinkled  Supplemental 

FINAL PROOF SURVEY

UNDER

R-38860	R-3418
38861	28946
R-41412	R-4592
41422	30517
R-43211	R-4840

Application No. 43212 Permit No. 31865

IN NAME OF

Frank F. & Alice I. Propes

Surveyed 31 Aug. 1972, by L.E. Gould