

# T. 39 S. R. 19 E. W.M.

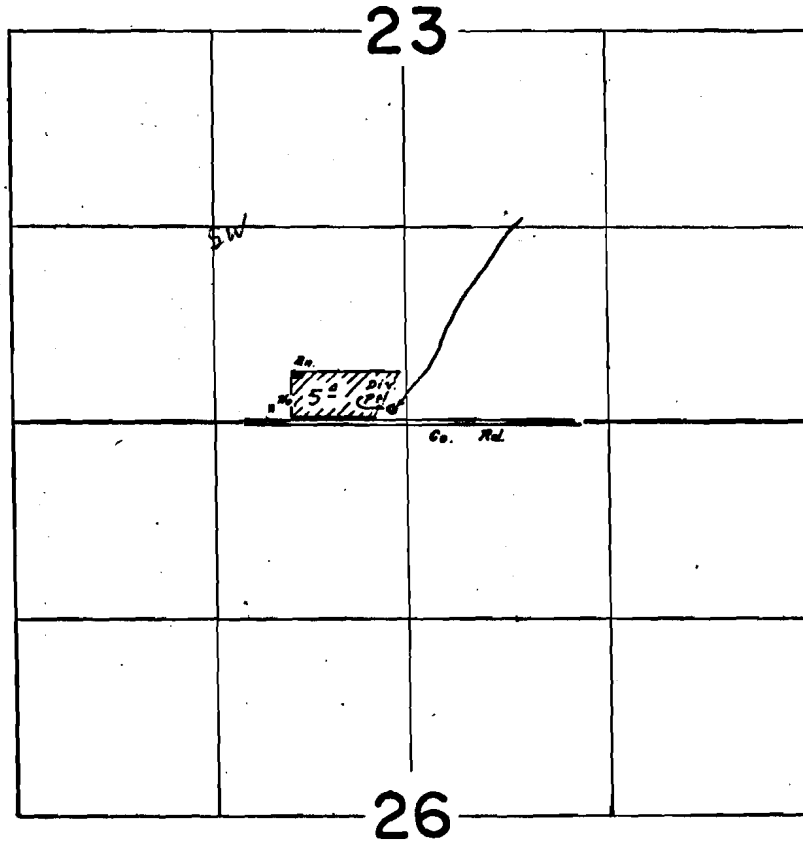

Div. Pt. 2c. 60' N. of 2580' E. from S.W. cor. Sec 23

## FINAL PROOF SURVEY UNDER

Application No. 41055 Permit No. 30640  
IN NAME OF

C. W. Rychard

Surveyed 15 Sept. 1972, by L. E. Gould