

# T. 4 S. R. 2 & 3 W. W.M.



## FINAL PROOF SURVEY UNDER

G-3888                      G-3655  
 Application No. 43491    Permit No. 32529  
 IN NAME OF

DAVIDSON FARMS INC.

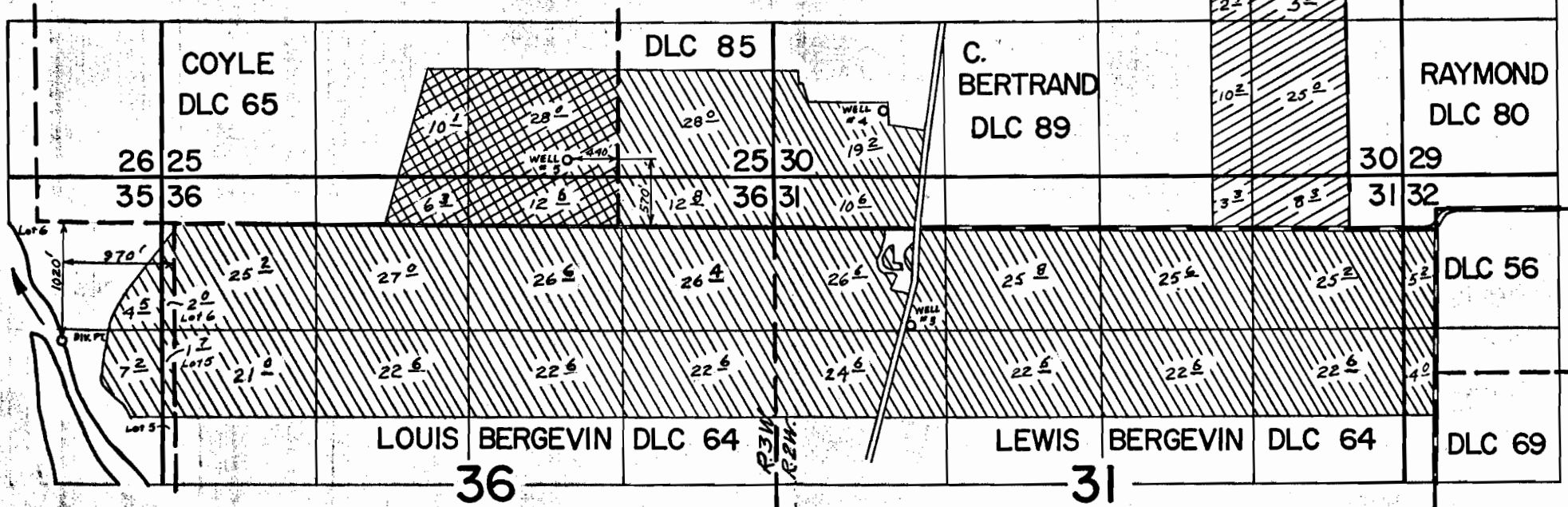
Surveyed AUG 17 1973, by L.E. GOULD



-  PRIMARY DIV. PT. LOCATED 1020' S & 960' W FROM NW COR. LOUIS BERGEVIN DLC 64
-  SUPPLEMENTAL DIV. PT. LOCATED 1020' S & 960' W FROM NW COR. LOUIS BERGEVIN DLC 64
-  SUPPLEMENTAL FROM WELL #5 570' N. & 440' W. FROM SE COR. COYLE DLC 65