

T. 4 S., R. 2 W. W.M.

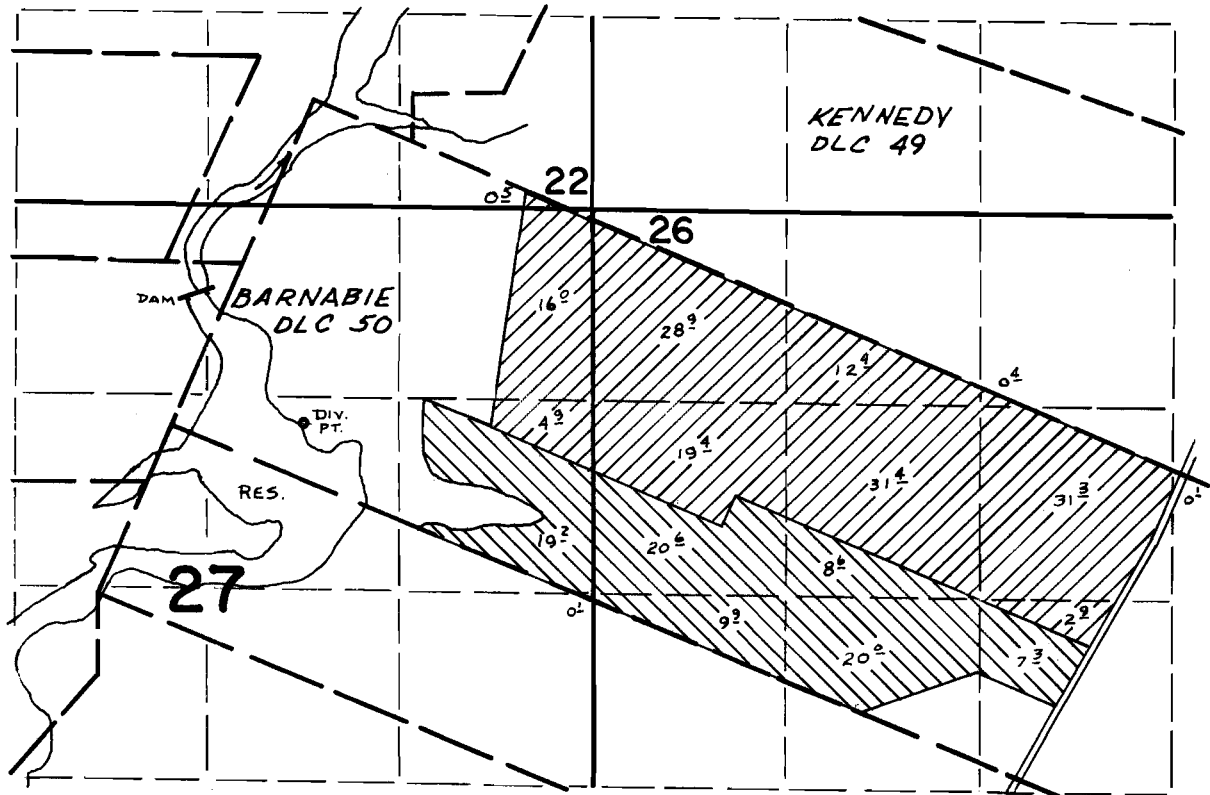

DAM LOCATED: 1400' S & 2090' W FROM W'L'Y INT. "L" COR KENNEDY DLC 49
 DIV. PT. LOCATED: 2290' S & 1380' W FROM W'L'Y INT. "L" COR KENNEDY DLC 49

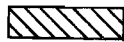

PRIMARY UNDER PERMIT # 32875



SUPPLEMENTAL UNDER PERMIT #32875

ALL LAND SUPPLEMENTAL UNDER PERMIT #33491

FINAL PROOF SURVEY UNDER

Application No. 44530 Permit No. 32875
44922 Permit No. 33491
 IN NAME OF

WALTER J. WILMES

Surveyed Oct. 6 1972, by D. Norby