

T.9S.R.2E.W.M.

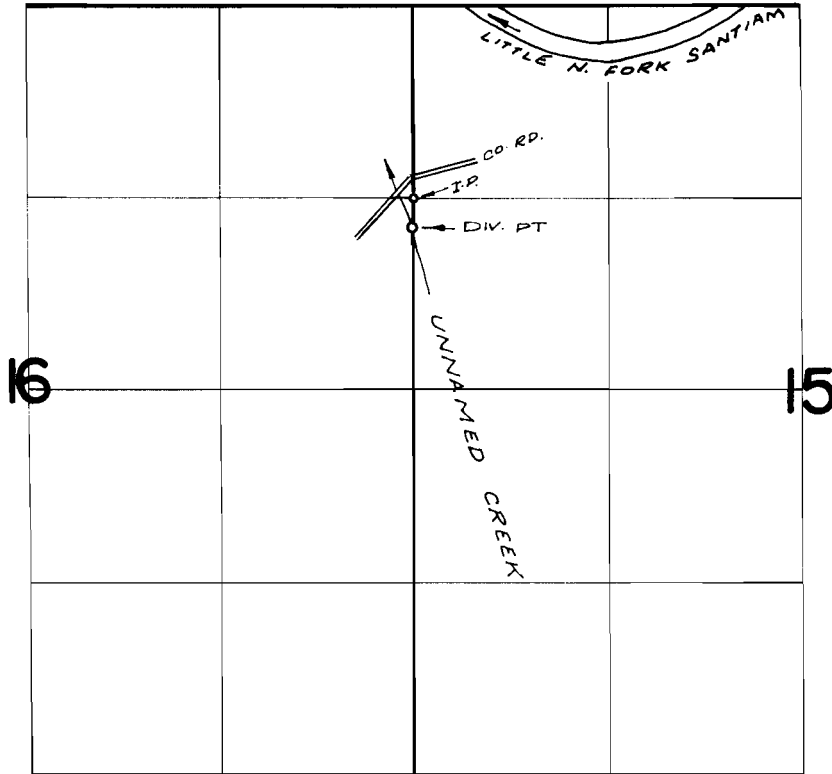

DIV. PT. LOC: 200' S & 10' W FROM N.E. COR. SE 1/4 NE 1/4 SEC. 16

FINAL PROOF SURVEY UNDER

Application No. 44964... Permit No. 33607..
IN NAME OF

ROBERT P. MOBLEY

Surveyed July 25, 1972, by R. MUCKEN