

T.2N.,R.4W.,W.M.

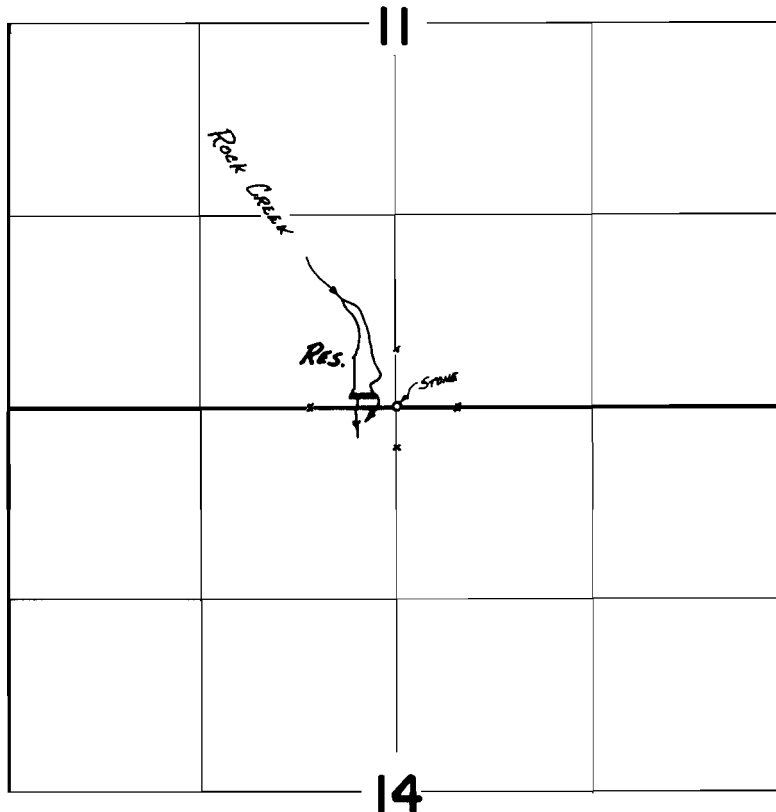

Div. Pt. Loc.: 50' N. & 250' W. from S. 1/4 cor. Sec. 11

**FINAL PROOF SURVEY**  
UNDER

R-47135                      R-5556  
Application No. 47136    Permit No. 34796  
IN NAME OF

JOHN F. WOOD

Surveyed JUNE 28 1973, by D. NORBY