

DAN HOUSE
KIAMATH

OREGON

Application Fee 10.00
Recording Fee 11.45
\$21.45

RECEIVED
MAR 6 1969
STATE ENGINEER
SALEM, OREGON

- ① - 8.0 ac.
- ② - 12.0 ac.
- ③ - 9.0 ac.
- ④ - 4.0 ac.
- ⑤ - 6.0 ac.
- ⑥ - 9.0 ac.
- ⑦ - 4.0 ac.
- ⑧ - 21.0 ac.

73.0 ACRES

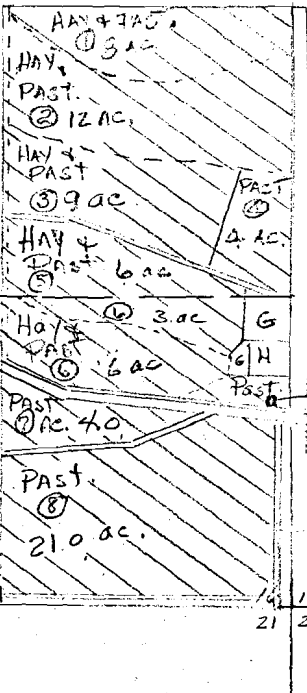

950 FT N Sec. CORNERS, 15-16-21422 T 38S R 10E
61 FT W LANE CORNER

TREE WELL 16 inches
1850 GALS per MIN TEST.
SUNNYSIDE DRIVE
T 38S R 10E

Application No. G-4804
Permit No. G 4529

REFERENCE

U. S. DEPARTMENT OF AGRICULTURE
SOIL CONSERVATION SERVICE
ASSISTING

SOIL CONSERVATION DISTRICT

DRAWING NUMBER

SHEET ___ OF ___ SHEETS

DATE ___